

DATE SUBMITTED: 7/12/85

PERMIT # \_\_\_\_\_

FEE 5.00

# FENCE PERMIT

GRAND JUNCTION PLANNING DEPARTMENT

BLDG ADDRESS: 2040 N 15<sup>th</sup> St

TAX SCHEDULE #: 2949-122-05-014

PROPERTY OWNER: Joe Rodriguez

PHONE: 245-1383

CONTRACTOR: SELF

PHONE: 245 1383

MATERIAL: CHAIN LINK FENCE

HEIGHT: 4 FOOT

\* PLOT PLAN

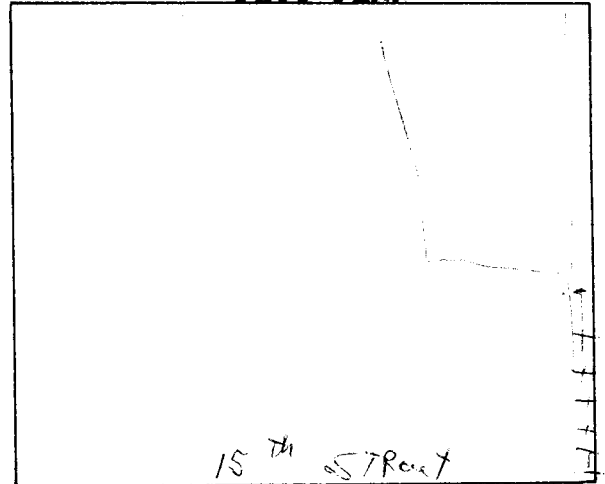

\*Showing Property Line Dimensions, Easements, Streets, all Structures, and Setbacks from Property Lines.

\*\*\*\*\*  
**FOR OFFICE USE ONLY**  
\*\*\*\*\*

ZONE: RSF 8

SETBACKS: F 50' S 3' R 3'

SPECIAL CONDITIONS: None

FINAL PERMIT

WILL REQUIRE SEPARATE PERMIT FROM THE CITY/COUNTY BUILDING DEPARTMENT.

\*\*\*\*\*

ANY MODIFICATION TO THIS APPROVED FENCE PERMIT MUST BE APPROVED, IN WRITING, BY THIS DEPARTMENT.

I HEREBY ACKNOWLEDGE THAT I HAVE READ THIS APPLICATION AND THE ABOVE IS CORRECT, AND I AGREE TO COMPLY WITH THE REQUIREMENTS ABOVE. FAILURE TO COMPLY SHALL RESULT IN LEGAL ACTION.

Kealia Rodriguez  
SIGNATURE

APPROVED BY: Kathy Portner

DATE APPROVED: 7/12/85