

DATE SUBMITTED: May 16, 1985

PERMIT # \_\_\_\_\_

FEE 5.00

# FENCE PERMIT

GRAND JUNCTION PLANNING DEPARTMENT

BLDG ADDRESS: 235 Hill, Grand Jct.  
 TAX SCHEDULE #: 2945-1A2-23-005  
 PROPERTY OWNER: Chloe Smithson  
 PHONE: 243-7851  
 CONTRACTOR: Self  
 PHONE: "  
 MATERIAL: Woven Wire (chain link)  
 HEIGHT: 4'

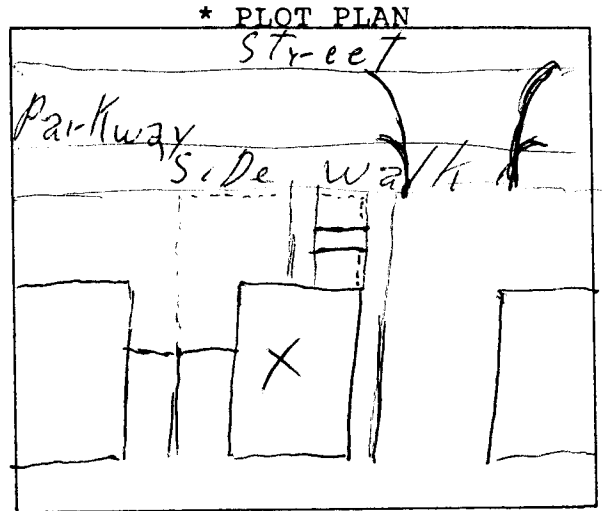

\*Showing Property Line Dimensions, Easements, Streets, all Structures, and Setbacks from Property Lines.

\*\*\*\*\*

### FOR OFFICE USE ONLY

ZONE: RMF-32

SETBACKS: F 45' & S 10' R 20'

SPECIAL CONDITIONS: \_\_\_\_\_

80' R.O.W. (fence @ 40' from E of street)

FINAL PERMIT

WILL REQUIRE SEPARATE PERMIT FROM THE CITY/COUNTY BUILDING DEPARTMENT.

\*\*\*\*\*

ANY MODIFICATION TO THIS APPROVED FENCE PERMIT MUST BE APPROVED, IN WRITING, BY THIS DEPARTMENT.

I HEREBY ACKNOWLEDGE THAT I HAVE READ THIS APPLICATION AND THE ABOVE IS CORRECT, AND I AGREE TO COMPLY WITH THE REQUIREMENTS ABOVE. FAILURE TO COMPLY SHALL RESULT IN LEGAL ACTION.

E.H. Smithson  
 SIGNATURE

APPROVED BY: Mike Seibold

DATE APPROVED: 5-16 85