

DATE SUBMITTED: 10/11/85

PERMIT # _____

FEE 5.00

FENCE PERMIT

GRAND JUNCTION PLANNING DEPARTMENT

BLDG ADDRESS: 2489 Commerce Blvd.
 TAX SCHEDULE #: 2945-091-00-082
 PROPERTY OWNER: Schlumberger
 PHONE: 245-3778
 CONTRACTOR: J & S Fence Co. Inc.
 PHONE: 243-2723
 MATERIAL: 4" Chain link
 HEIGHT: 72"

Commerce Blvd
* PLOT PLAN

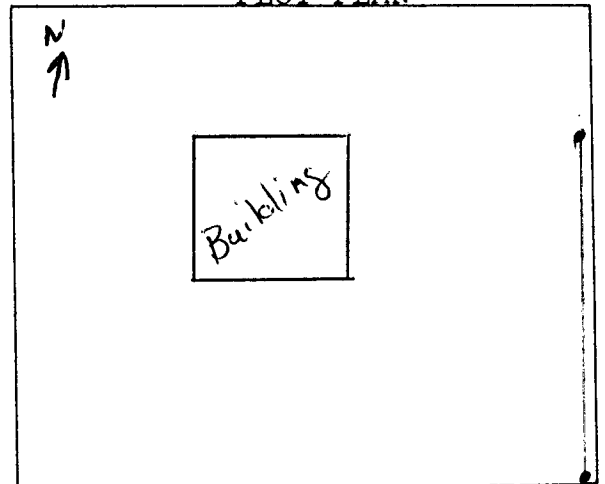

*Showing Property Line Dimensions, Easements, Streets, all Structures, and Setbacks from Property Lines.

FOR OFFICE USE ONLY

ZONE: C-2

SETBACKS: F 40 S 0 R 0

SPECIAL CONDITIONS: _____

FINAL PERMIT

WILL REQUIRE SEPARATE PERMIT FROM THE CITY/COUNTY BUILDING DEPARTMENT.

ANY MODIFICATION TO THIS APPROVED FENCE PERMIT MUST BE APPROVED, IN WRITING, BY THIS DEPARTMENT.

I HEREBY ACKNOWLEDGE THAT I HAVE READ THIS APPLICATION AND THE ABOVE IS CORRECT, AND I AGREE TO COMPLY WITH THE REQUIREMENTS ABOVE. FAILURE TO COMPLY SHALL RESULT IN LEGAL ACTION.

Linda Shute
 SIGNATURE

APPROVED BY: Kathy Postma

DATE APPROVED: 10/11/85