

DATE SUBMITTED: Sept 4, 1986

PERMIT # \_\_\_\_\_

FEE 500

# FENCE PERMIT

GRAND JUNCTION PLANNING DEPARTMENT

BLDG ADDRESS: 2865 ERM AVE  
 TAX SCHEDULE #: 2443-074-00-031  
 PROPERTY OWNER: DALE L MARTIN  
 PHONE: 242 4775  
 CONTRACTOR: SAME  
 PHONE: \_\_\_\_\_  
 MATERIAL: cedar rail  
 HEIGHT: 48"

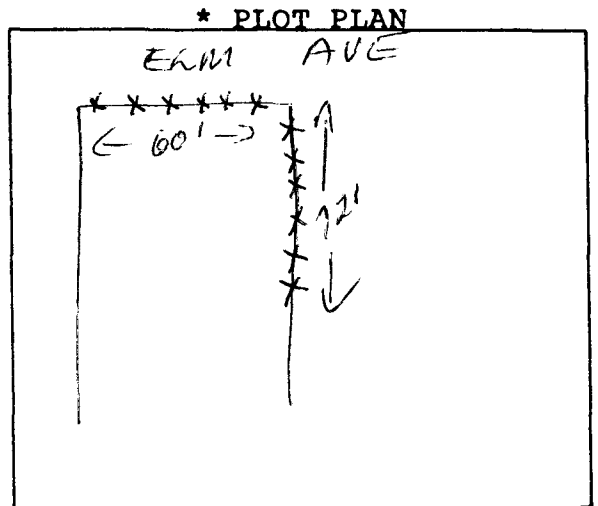

\*Showing Property Line Dimensions, Easements, Streets, all Structures, and Setbacks from Property Lines.

\*\*\*\*\*  
 FOR OFFICE USE ONLY

ZONE: RMF-16

SETBACKS: F N/A S N/A R N/A

SPECIAL CONDITIONS: NONE

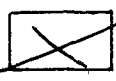

FINAL PERMIT



WILL REQUIRE SEPARATE PERMIT FROM THE CITY/COUNTY BUILDING DEPARTMENT.

\*\*\*\*\*

ANY MODIFICATION TO THIS APPROVED FENCE PERMIT MUST BE APPROVED, IN WRITING, BY THIS DEPARTMENT.

I HEREBY ACKNOWLEDGE THAT I HAVE READ THIS APPLICATION AND THE ABOVE IS CORRECT, AND I AGREE TO COMPLY WITH THE REQUIREMENTS ABOVE. FAILURE TO COMPLY SHALL RESULT IN LEGAL ACTION.

APPROVED BY: [Signature]  
 DATE APPROVED: Sept 4, 1986

[Signature]  
 SIGNATURE