

DATE SUBMITTED: 5/13/87

PERMIT # _____

FEE \$5.00

FENCE PERMIT

GRAND JUNCTION PLANNING DEPARTMENT

BLDG ADDRESS: 1349/47 TEXAS

TAX SCHEDULE #: 2945-123-13-015

PROPERTY OWNER: POPPY WOODY

PHONE: 241-6786

CONTRACTOR: _____

PHONE: _____

MATERIAL: SOLID WOOD

HEIGHT: 2 1/2' FRONT ; 6' REAR

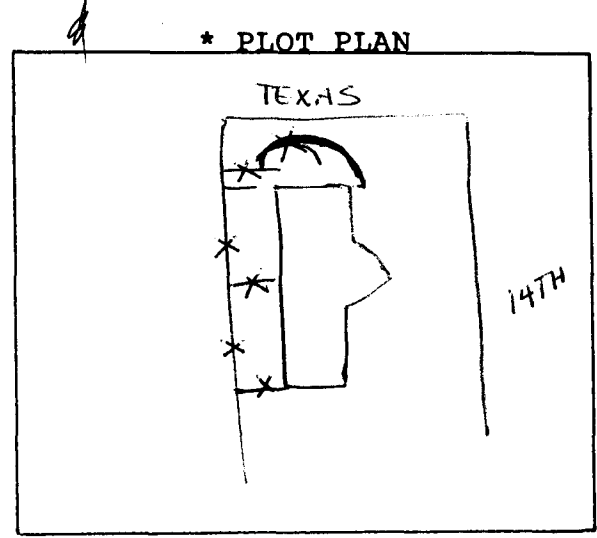

*Showing Property Line Dimensions, Easements, Streets, all Structures, and Setbacks from Property Lines.

FOR OFFICE USE ONLY

ZONE: RMF-32

SETBACKS: F N/A S _____ R _____
N/A - 2 1/2' in front to property line, 6' along side

SPECIAL CONDITIONS: _____

FINAL PERMIT

WILL REQUIRE SEPARATE PERMIT FROM THE CITY/COUNTY BUILDING DEPARTMENT.

ANY MODIFICATION TO THIS APPROVED FENCE PERMIT MUST BE APPROVED, IN WRITING, BY THIS DEPARTMENT.

I HEREBY ACKNOWLEDGE THAT I HAVE READ THIS APPLICATION AND THE ABOVE IS CORRECT, AND I AGREE TO COMPLY WITH THE REQUIREMENTS ABOVE. FAILURE TO COMPLY SHALL RESULT IN LEGAL ACTION.

PJ Woody
SIGNATURE

APPROVED BY: Kathy Postma

DATE APPROVED: 5/13/87