

DATE SUBMITTED: AUG. 14, 1987

PERMIT # \_\_\_\_\_  
FEE \$ 500

# FENCE PERMIT

GRAND JUNCTION PLANNING DEPARTMENT

BLDG ADDRESS: 1502 N 12  
TAX SCHEDULE #: \_\_\_\_\_  
PROPERTY OWNER: L.D.S. Church  
PHONE: 242-5155  
CONTRACTOR: Yancy Dalton  
PHONE: 464-5448  
MATERIAL: Fencing chain link  
HEIGHT: 4'

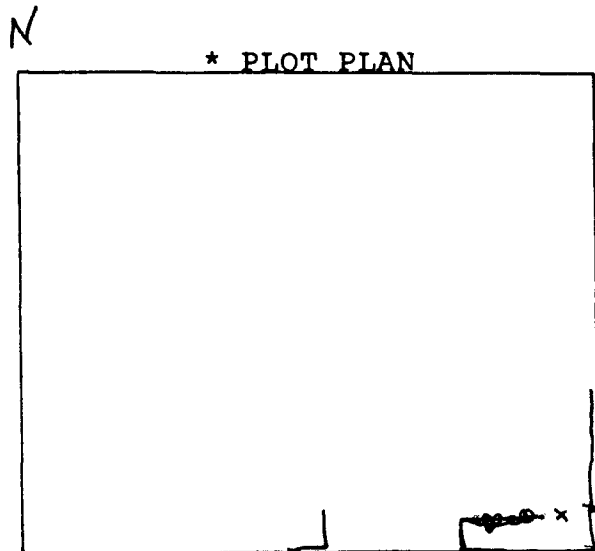

\*Showing Property Line Dimensions, Easements, Streets, all Structures, and Setbacks from Property Lines. *ELM*

\*\*\*\*\*

### FOR OFFICE USE ONLY

ZONE: RMF-64

SETBACKS: F N/A S N/A R N/A

SPECIAL CONDITIONS: \_\_\_\_\_

Revocable Permit  
Resolution # 29-87



FINAL PERMIT

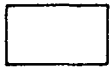

WILL REQUIRE SEPARATE PERMIT FROM THE CITY/COUNTY BUILDING DEPARTMENT.

\*\*\*\*\*

ANY MODIFICATION TO THIS APPROVED FENCE PERMIT MUST BE APPROVED, IN WRITING, BY THIS DEPARTMENT.

I HEREBY ACKNOWLEDGE THAT I HAVE READ THIS APPLICATION AND THE ABOVE IS CORRECT, AND I AGREE TO COMPLY WITH THE REQUIREMENTS ABOVE. FAILURE TO COMPLY SHALL RESULT IN LEGAL ACTION.

APPROVED BY: [Signature]

DATE APPROVED: AUG. 14, 1987

Yancy Lee Dalton  
SIGNATURE