

DATE SUBMITTED: 4/28/87

PERMIT # \_\_\_\_\_

FEE \$5.00

# FENCE PERMIT

GRAND JUNCTION PLANNING DEPARTMENT

BLDG ADDRESS: 615 N. 17<sup>th</sup>

TAX SCHEDULE #: 2945-132-04-009

PROPERTY OWNER: ROBT. F. MAFFEY

PHONE: 242-0320

CONTRACTOR: SELF

PHONE: ✓

MATERIAL: Woodslat & Rail

HEIGHT: 5'6" to setback line  
Then 30" high 2 rail  
on both sides in front  
of setback line.

\* PLOT PLAN

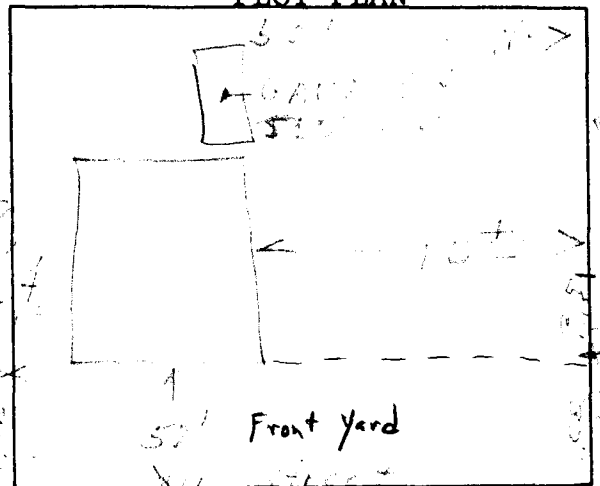

\*Showing Property Line Dimensions, Easements, Streets, all Structures, and Setbacks from Property Lines.

\*\*\*\*\*

### FOR OFFICE USE ONLY

ZONE: RSF-8

SETBACKS: F 50' S 5' R 15'

SPECIAL CONDITIONS: \_\_\_\_\_

FINAL PERMIT

WILL REQUIRE SEPARATE PERMIT FROM THE CITY/COUNTY BUILDING DEPARTMENT.

\*\*\*\*\*

ANY MODIFICATION TO THIS APPROVED FENCE PERMIT MUST BE APPROVED, IN WRITING, BY THIS DEPARTMENT.

I HEREBY ACKNOWLEDGE THAT I HAVE READ THIS APPLICATION AND THE ABOVE IS CORRECT, AND I AGREE TO COMPLY WITH THE REQUIREMENTS ABOVE. FAILURE TO COMPLY SHALL RESULT IN LEGAL ACTION.

Robert F. Maffey  
SIGNATURE

APPROVED BY: Gary F. Letke

DATE APPROVED: 4/28/87