

DATE SUBMITTED: 11/27/87

PERMIT # _____

FEE N/C

FENCE PERMIT

GRAND JUNCTION PLANNING DEPARTMENT

BLDG ADDRESS: 913 N. 7th St.

TAX SCHEDULE #: 2945-141-12-003

PROPERTY OWNER: Grand Valley National Bank

PHONE: 241-4400

CONTRACTOR: William Price

PHONE: _____

MATERIAL: wood

HEIGHT: 5'

* PLOT PLAN

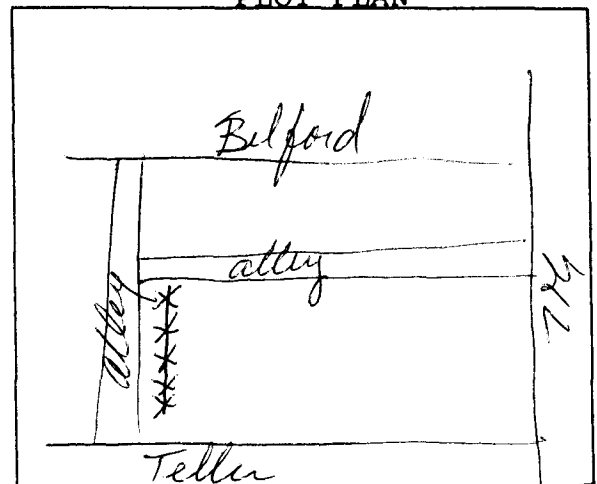

*Showing Property Line Dimensions, Easements, Streets, all Structures, and Setbacks from Property Lines.

FOR OFFICE USE ONLY

ZONE: B3

SETBACKS: F property line S _____ R _____

SPECIAL CONDITIONS: The fence shall end 10' behind the existing sidewalk on Teller Ave. and the proposed sidewalk on Belford for proper sight distance

FINAL PERMIT

WILL REQUIRE SEPARATE PERMIT FROM THE CITY/COUNTY BUILDING DEPARTMENT.

ANY MODIFICATION TO THIS APPROVED FENCE PERMIT MUST BE APPROVED, IN WRITING, BY THIS DEPARTMENT.

I HEREBY ACKNOWLEDGE THAT I HAVE READ THIS APPLICATION AND THE ABOVE IS CORRECT, AND I AGREE TO COMPLY WITH THE REQUIREMENTS ABOVE. FAILURE TO COMPLY SHALL RESULT IN LEGAL ACTION.

Robert D. Jenkins
SIGNATURE

APPROVED BY: Kathy Portner

DATE APPROVED: 11/30/87