

DATE SUBMITTED: 8-2-88

PERMIT # \_\_\_\_\_

FEE 5.00

# FENCE PERMIT

GRAND JUNCTION PLANNING DEPARTMENT

BLDG ADDRESS: ~~114 N. 12th~~ 114 N. 12th  
 TAX SCHEDULE #: 2945-133-12-001  
 PROPERTY OWNER: Lewis Inulija  
 PHONE: 245-3063  
 CONTRACTOR: A.E. S. Fence Co. Inc.  
 PHONE: 243-2723  
 MATERIAL: Chain link  
 HEIGHT: 48"

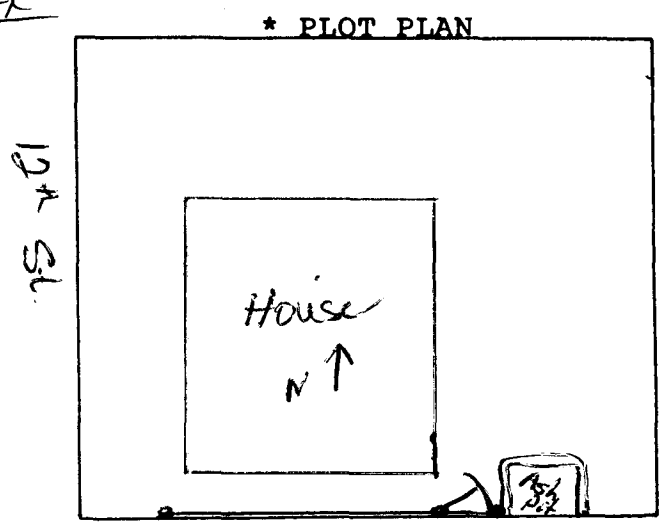

\*Showing Property Line Dimensions, Easements, Streets, all Structures, and Setbacks from Property Lines.

\*\*\*\*\*

### FOR OFFICE USE ONLY

ZONE: RST-8

SETBACKS: F PL S PL R PL

SPECIAL CONDITIONS: \_\_\_\_\_

FINAL PERMIT

WILL REQUIRE SEPARATE PERMIT FROM THE CITY/COUNTY BUILDING DEPARTMENT.

\*\*\*\*\*

ANY MODIFICATION TO THIS APPROVED FENCE PERMIT MUST BE APPROVED, IN WRITING, BY THIS DEPARTMENT.

I HEREBY ACKNOWLEDGE THAT I HAVE READ THIS APPLICATION AND THE ABOVE IS CORRECT, AND I AGREE TO COMPLY WITH THE REQUIREMENTS ABOVE. FAILURE TO COMPLY SHALL RESULT IN LEGAL ACTION.

Howard Tan  
SIGNATURE

APPROVED BY: Linda Wetzel

DATE APPROVED: 8-5-88