

DATE SUBMITTED: 3/2/88

PERMIT # _____

FEE N/A

FENCE PERMIT

GRAND JUNCTION PLANNING DEPARTMENT

BLDG ADDRESS: 1323 N. 25th

TAX SCHEDULE #: _____

PROPERTY OWNER: Imogene Wiley

PHONE: _____

CONTRACTOR: Reed Construction

PHONE: _____

MATERIAL: _____

HEIGHT: _____

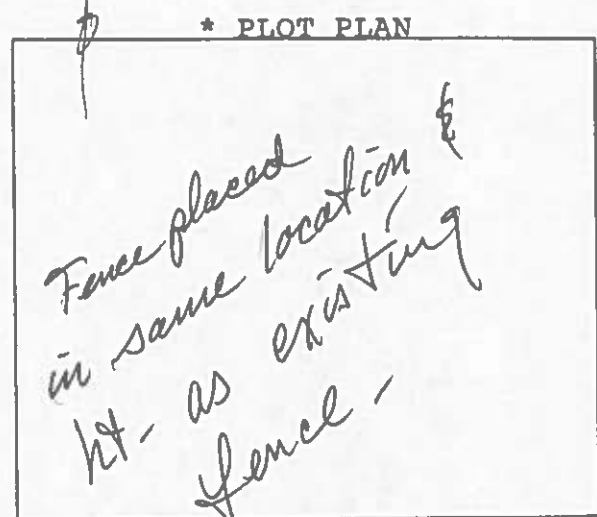

*Showing Property Line Dimensions, Easements, Streets, all Structures, and Setbacks from Property Lines.

FOR OFFICE USE ONLY

ZONE: _____

SETBACKS: F _____ S _____ R _____

TRAILINGS PROJECT
SPECIAL CONDITIONS: _____

FINAL PERMIT

WILL REQUIRE SEPARATE PERMIT FROM THE CITY/COUNTY BUILDING DEPARTMENT.

ANY MODIFICATION TO THIS APPROVED FENCE PERMIT MUST BE APPROVED, IN WRITING, BY THIS DEPARTMENT.

I HEREBY ACKNOWLEDGE THAT I HAVE READ THIS APPLICATION AND THE ABOVE IS CORRECT, AND I AGREE TO COMPLY WITH THE REQUIREMENTS ABOVE. FAILURE TO COMPLY SHALL RESULT IN LEGAL ACTION.

APPROVED BY: [Signature]
DATE APPROVED: 3/2/88

[Signature]
SIGNATURE