

DATE SUBMITTED: 7-18-89

PERMIT # _____

FEE 5.00

FENCE PERMIT

GRAND JUNCTION PLANNING DEPARTMENT

BLDG ADDRESS: 2205 N. 22nd
 TAX SCHEDULE #: 2445-121-18-021
 PROPERTY OWNER: Securing Trust Investments
 PHONE: 1011 1/2th St. Grand Jct
 CONTRACTOR: J&S Fence Co. Inc.
 PHONE: 243-2723
 MATERIAL: Chain link
 HEIGHT: 48"

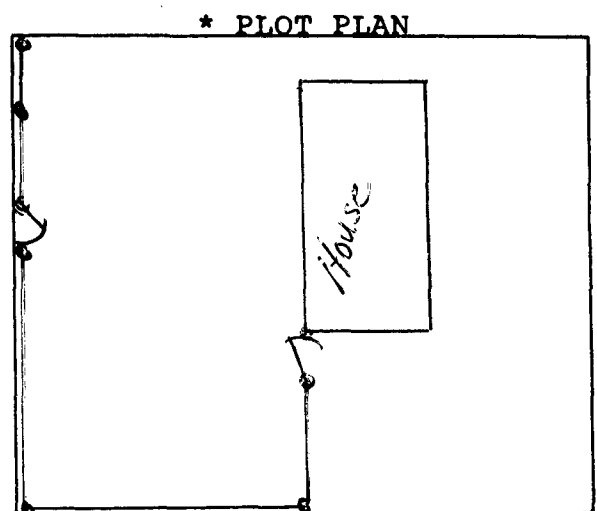

*Showing Property Line Dimensions, Easements, Streets, all Structures, and Setbacks from Property Lines.

FOR OFFICE USE ONLY

ZONE: R-1-0

SETBACKS: F 12 S 12 R 12

SPECIAL CONDITIONS: _____

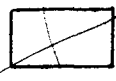

FINAL PERMIT

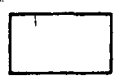

WILL REQUIRE SEPARATE PERMIT FROM THE CITY/COUNTY BUILDING DEPARTMENT.

ANY MODIFICATION TO THIS APPROVED FENCE PERMIT MUST BE APPROVED, IN WRITING, BY THIS DEPARTMENT.

I HEREBY ACKNOWLEDGE THAT I HAVE READ THIS APPLICATION AND THE ABOVE IS CORRECT, AND I AGREE TO COMPLY WITH THE REQUIREMENTS ABOVE. FAILURE TO COMPLY SHALL RESULT IN LEGAL ACTION.

Howard Tan
SIGNATURE

APPROVED BY: [Signature]

DATE APPROVED: 7-21-89