

DATE SUBMITTED: 3 4/14/88

PERMIT # \_\_\_\_\_

FEE \$ 5.00

# FENCE PERMIT

GRAND JUNCTION PLANNING DEPARTMENT

BLDG ADDRESS: 2842 1/2 GD. CASCADE RD.

TAX SCHEDULE #: 2943-172-16-027 FENCE

PROPERTY OWNER: PETER + FERNESTINE PLOTNICK

PHONE: 243-3831

CONTRACTOR: SELF

PHONE: \_\_\_\_\_

MATERIAL: CEDAR BOARDS + POSTS

HEIGHT: 5' - 10"

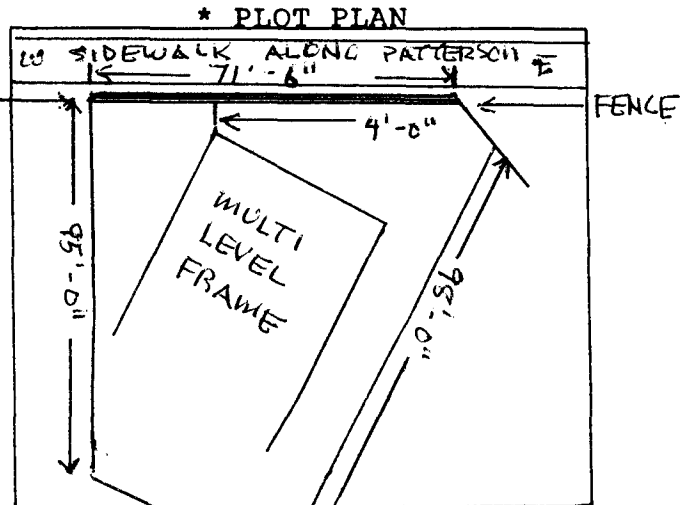

\*Showing Property Line Dimensions, Easements, Streets, all Structures, and Setbacks from Property Lines.

\*\*\*\*\*  
FOR OFFICE USE ONLY

ZONE: PR8

SETBACKS: F as per plan S \_\_\_\_\_ R \_\_\_\_\_

SPECIAL CONDITIONS: \_\_\_\_\_

FINAL PERMIT

WILL REQUIRE SEPARATE PERMIT FROM THE CITY/COUNTY BUILDING DEPARTMENT.

\*\*\*\*\*

ANY MODIFICATION TO THIS APPROVED FENCE PERMIT MUST BE APPROVED, IN WRITING, BY THIS DEPARTMENT.

I HEREBY ACKNOWLEDGE THAT I HAVE READ THIS APPLICATION AND THE ABOVE IS CORRECT, AND I AGREE TO COMPLY WITH THE REQUIREMENTS ABOVE. FAILURE TO COMPLY SHALL RESULT IN LEGAL ACTION.

Peter Plotnick  
SIGNATURE

APPROVED BY: [Signature]

DATE APPROVED: 4/14/88