

DATE SUBMITTED: 6/29/88

PERMIT # \_\_\_\_\_

FEE 5.00

# FENCE PERMIT

## GRAND JUNCTION PLANNING DEPARTMENT

BLDG ADDRESS: 841 Lite Ave

TAX SCHEDULE #: 2975-14-33-106

PROPERTY OWNER: Federico Vargas

PHONE: 243-7404

CONTRACTOR: \_\_\_\_\_

PHONE: \_\_\_\_\_

MATERIAL: WOOD

HEIGHT: 4 feet

\* PLOT PLAN

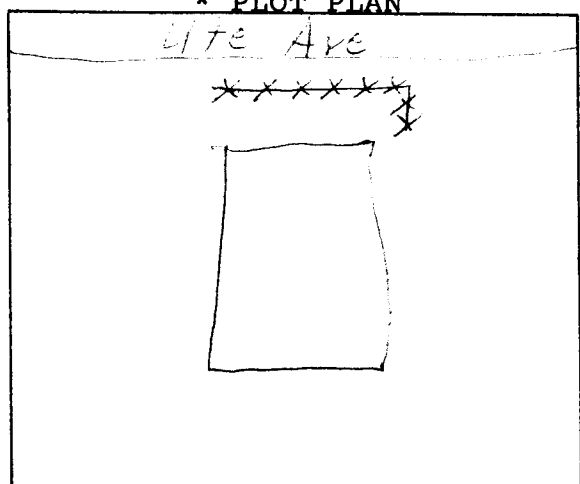

\*Showing Property Line Dimensions, Easements, Streets, all Structures, and Setbacks from Property Lines.

\*\*\*\*\*

### FOR OFFICE USE ONLY

ZONE: R-2

SETBACKS: F 14' 0" S 10' R \_\_\_\_\_

SPECIAL CONDITIONS: \_\_\_\_\_

FINAL PERMIT

WILL REQUIRE SEPARATE PERMIT FROM THE CITY/COUNTY BUILDING DEPARTMENT.

\*\*\*\*\*

ANY MODIFICATION TO THIS APPROVED FENCE PERMIT MUST BE APPROVED, IN WRITING, BY THIS DEPARTMENT.

I HEREBY ACKNOWLEDGE THAT I HAVE READ THIS APPLICATION AND THE ABOVE IS CORRECT, AND I AGREE TO COMPLY WITH THE REQUIREMENTS ABOVE. FAILURE TO COMPLY SHALL RESULT IN LEGAL ACTION.

Federico Vargas  
SIGNATURE

APPROVED BY: Kathy Post

DATE APPROVED: 6/29/88