

DATE SUBMITTED: 11/18/88

PERMIT # \_\_\_\_\_

FEE no fee

# FENCE PERMIT

## GRAND JUNCTION PLANNING DEPARTMENT

BLDG ADDRESS: 919/929 MAIN ST.  
 TAX SCHEDULE #: 2945-144-22-003  
2945-144-22-004  
 PROPERTY OWNER: Marie SHAFER  
 PHONE: 245-7753  
 CONTRACTOR: \_\_\_\_\_  
 PHONE: \_\_\_\_\_  
 MATERIAL: solid wood  
 HEIGHT: not to exceed 6'

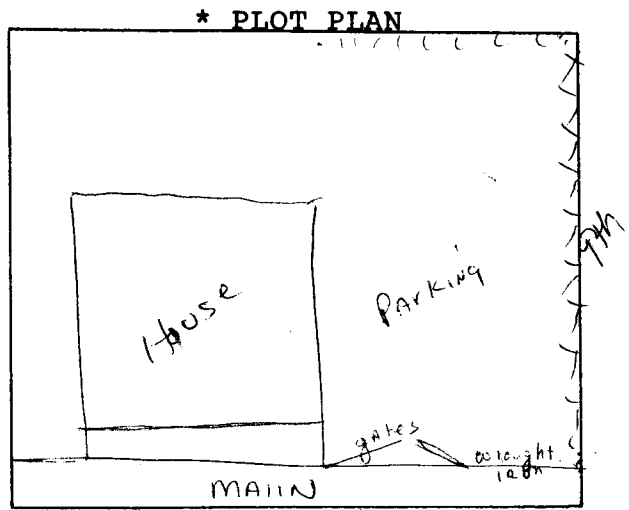

\*Showing Property Line Dimensions, Easements, Streets, all Structures, and Setbacks from Property Lines.

\*\*\*\*\*

**FOR OFFICE USE ONLY**

ZONE: B-3

SETBACKS: F 25' S 0' R 0'

SPECIAL CONDITIONS: replace existing fence. Same location. fence must be on owners property.

FINAL PERMIT

WILL REQUIRE SEPARATE PERMIT FROM THE CITY/COUNTY BUILDING DEPARTMENT.

\*\*\*\*\*

ANY MODIFICATION TO THIS APPROVED FENCE PERMIT MUST BE APPROVED, IN WRITING, BY THIS DEPARTMENT.

I HEREBY ACKNOWLEDGE THAT I HAVE READ THIS APPLICATION AND THE ABOVE IS CORRECT, AND I AGREE TO COMPLY WITH THE REQUIREMENTS ABOVE. FAILURE TO COMPLY SHALL RESULT IN LEGAL ACTION.

J. Marie Shaffer  
SIGNATURE

APPROVED BY: [Signature]

DATE APPROVED: 11/18/88