

DATE SUBMITTED: 8-14-89

PERMIT # \_\_\_\_\_

FEE \$50

# FENCE PERMIT

GRAND JUNCTION PLANNING DEPARTMENT

BLDG ADDRESS: 1930 N. 6th

TAX SCHEDULE #: 2945-112-05-013

PROPERTY OWNER: Yolanda Day

PHONE: \_\_\_\_\_

CONTRACTOR: Ac Gussio

PHONE: 245-2979

MATERIAL: Scrub Wood

HEIGHT: 2'4" TO 5'

\* PLOT PLAN

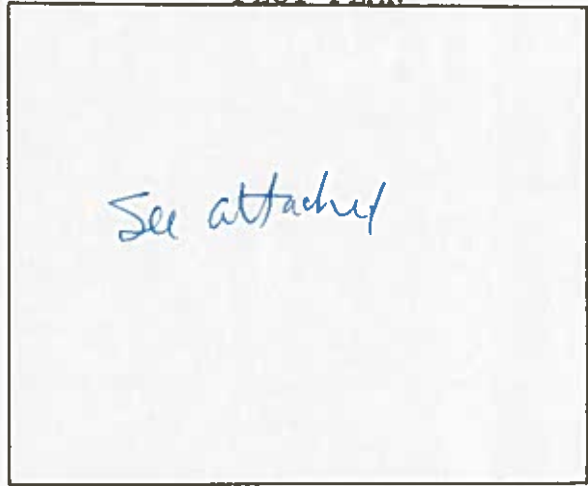

\*Showing Property Line Dimensions, Easements, Streets, all Structures, and Setbacks from Property Lines.

\*\*\*\*\*

### FOR OFFICE USE ONLY

ZONE: RSF-5

SETBACKS: F 20 PL S PL R PL

SPECIAL CONDITIONS: Fence 30" high 20 feet from PL

FINAL PERMIT

WILL REQUIRE SEPARATE PERMIT FROM THE CITY/COUNTY BUILDING DEPARTMENT.

\*\*\*\*\*

ANY MODIFICATION TO THIS APPROVED FENCE PERMIT MUST BE APPROVED, IN WRITING, BY THIS DEPARTMENT.

I HEREBY ACKNOWLEDGE THAT I HAVE READ THIS APPLICATION AND THE ABOVE IS CORRECT, AND I AGREE TO COMPLY WITH THE REQUIREMENTS ABOVE. FAILURE TO COMPLY SHALL RESULT IN LEGAL ACTION.

[Signature]  
SIGNATURE

APPROVED BY: [Signature]

DATE APPROVED: 8-14-89

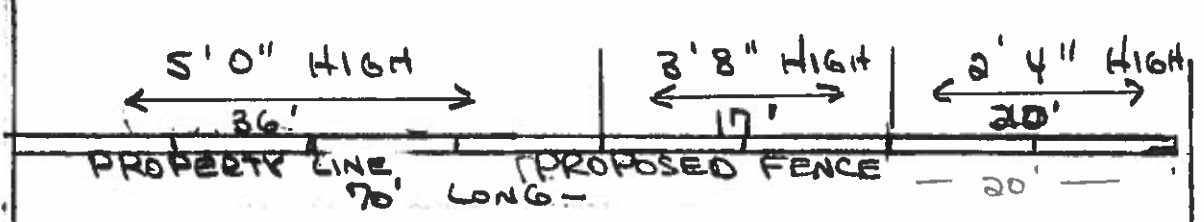

STREET  
1930 N. 6<sup>TH</sup> GRAND ST., CO. YOLAND DAY  
SIDEWALK

PROPERTY LINE

4x4x16 SCUMP BRICKS - X 3 4x4x4 OPENINGS

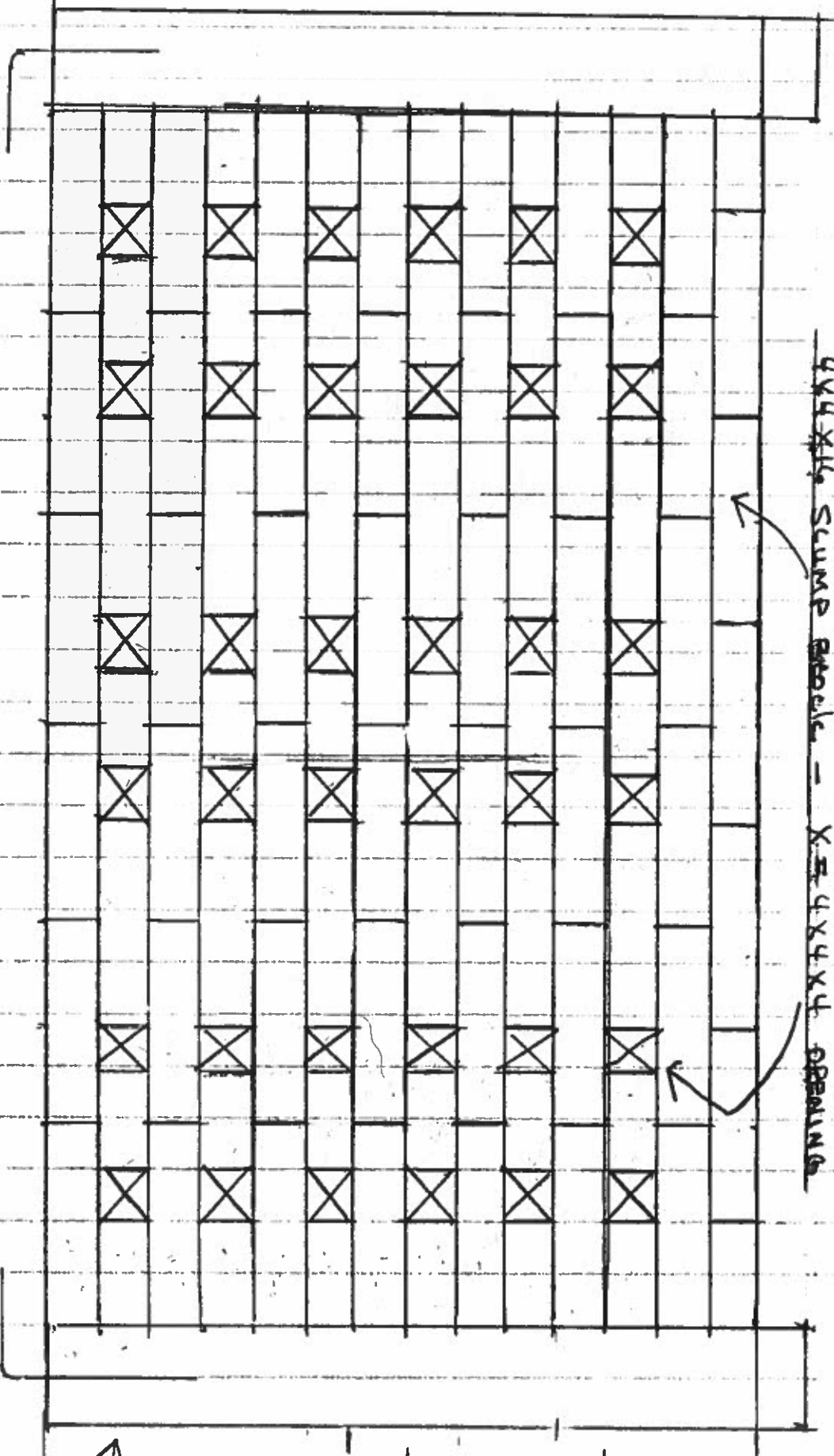

5'0"

3'8"

2'4"

CONCRETE FOOTING 2'-4" REBAR  
8" WIDE X 8" DEEP

Mrs Day

1930 N. 6th

GRAND ST. CO.

PLASTER OR INTERLOCKS

WITH 2" 4 REBAR

8x4x16 SCUMP BRICK