

DATE SUBMITTED: 7/24/89

PERMIT # \_\_\_\_\_

FEE 5.00

# FENCE PERMIT

GRAND JUNCTION PLANNING DEPARTMENT

→ 2

BLDG ADDRESS: 2843 ELM AVE

TAX SCHEDULE #: 2943-073-00-095

PROPERTY OWNER: A. I. GONZALES

PHONE: 245-1445

CONTRACTOR: \_\_\_\_\_

PHONE: \_\_\_\_\_

MATERIAL: Wood Privacy fence

HEIGHT: 6

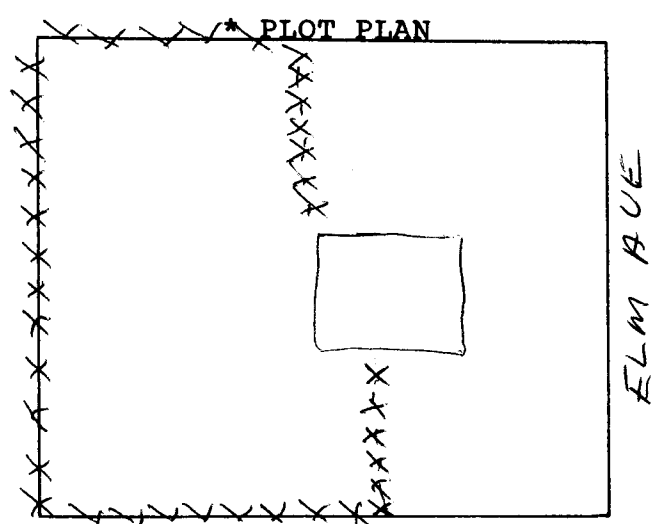

\*Showing Property Line Dimensions, Easements, Streets, all Structures, and Setbacks from Property Lines.

\*\*\*\*\*

### FOR OFFICE USE ONLY

ZONE: R5F-8

SETBACKS: F property line S \_\_\_\_\_ R \_\_\_\_\_

SPECIAL CONDITIONS: 6' privacy fence allowed on property line if behind the front of the house

FINAL PERMIT

WILL REQUIRE SEPARATE PERMIT FROM THE CITY/COUNTY BUILDING DEPARTMENT.

\*\*\*\*\*

ANY MODIFICATION TO THIS APPROVED FENCE PERMIT MUST BE APPROVED, IN WRITING, BY THIS DEPARTMENT.

I HEREBY ACKNOWLEDGE THAT I HAVE READ THIS APPLICATION AND THE ABOVE IS CORRECT, AND I AGREE TO COMPLY WITH THE REQUIREMENTS ABOVE. FAILURE TO COMPLY SHALL RESULT IN LEGAL ACTION.

A. I. Gonzales  
SIGNATURE

APPROVED BY: Kathy Poston

DATE APPROVED: 7/24/89