

DATE SUBMITTED: 3-3-89

PERMIT # _____

FEE 5.00

FENCE PERMIT

GRAND JUNCTION PLANNING DEPARTMENT

FENCE
• PROP STAKE
• 200 PERS

BLDG ADDRESS: 291 27 3/8 Rd

TAX SCHEDULE #: 2945-252-00-095

PROPERTY OWNER: [REDACTED]

PHONE: 241-1239

CONTRACTOR: J E S Fence Co. Inc.

PHONE: 243-2723

MATERIAL: Chain link

HEIGHT: 48"

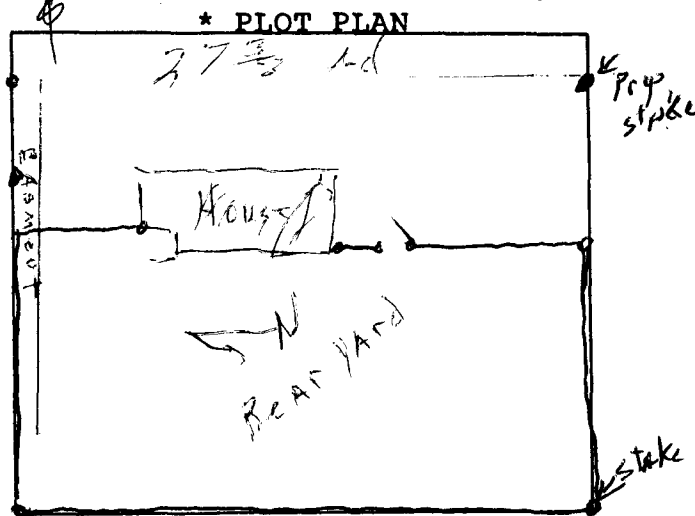

*Showing Property Line Dimensions, Easements, Streets, all Structures, and Setbacks from Property Lines.

FOR OFFICE USE ONLY

ZONE: RSF-8

SETBACKS: F 20' S 0' R 0'

SPECIAL CONDITIONS: _____



FINAL PERMIT



WILL REQUIRE SEPARATE PERMIT FROM THE CITY/COUNTY BUILDING DEPARTMENT.

ANY MODIFICATION TO THIS APPROVED FENCE PERMIT MUST BE APPROVED, IN WRITING, BY THIS DEPARTMENT.

I HEREBY ACKNOWLEDGE THAT I HAVE READ THIS APPLICATION AND THE ABOVE IS CORRECT, AND I AGREE TO COMPLY WITH THE REQUIREMENTS ABOVE. FAILURE TO COMPLY SHALL RESULT IN LEGAL ACTION.

[Signature]
SIGNATURE

APPROVED BY: [Signature]

DATE APPROVED: 3/7/89