

DATE SUBMITTED: 1-23-89

PERMIT # _____

FEE 75.00

FENCE PERMIT

GRAND JUNCTION PLANNING DEPARTMENT

BLDG ADDRESS: 710 Hill Ave

TAX SCHEDULE #: 89415-111-11-006

PROPERTY OWNER: Nancy Stroman

PHONE: 245-8599

CONTRACTOR: Taylor Fence Co

PHONE: 241-1473

MATERIAL: 6' Privacy Fence

HEIGHT: 6'

* PLOT PLAN

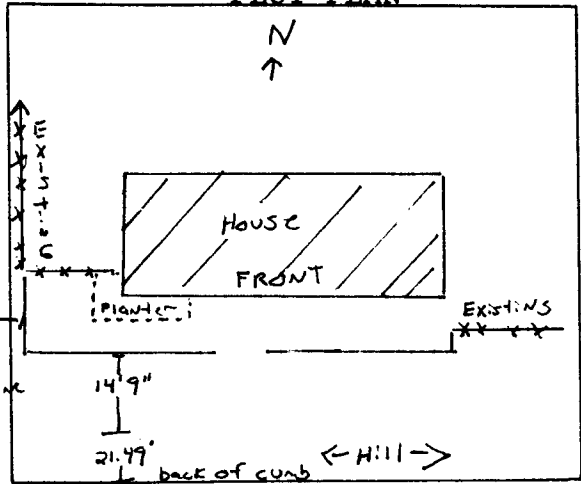

*Showing Property Line Dimensions, Easements, Streets, all Structures, and Setbacks from Property Lines.

FOR OFFICE USE ONLY

ZONE: RMS-32

* See # 186 12
SETBACKS: F _____ S _____ R _____

SPECIAL CONDITIONS: Set back varied

along 7th from 20 to 19 feet
Hill Ave from 50 to 49 feet

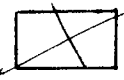

FINAL PERMIT

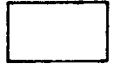

WILL REQUIRE SEPARATE PERMIT FROM THE CITY/COUNTY BUILDING DEPARTMENT.

ANY MODIFICATION TO THIS APPROVED FENCE PERMIT MUST BE APPROVED, IN WRITING, BY THIS DEPARTMENT.

I HEREBY ACKNOWLEDGE THAT I HAVE READ THIS APPLICATION AND THE ABOVE IS CORRECT, AND I AGREE TO COMPLY WITH THE REQUIREMENTS ABOVE. FAILURE TO COMPLY SHALL RESULT IN LEGAL ACTION.

[Signature]
SIGNATURE

APPROVED BY: Linda Witzel

DATE APPROVED: 1-23-89