

DATE SUBMITTED: 4-7-89
803 W. Main → 2995-154-18-945
2549 Price Rd → 2995-154-13-941

PERMIT # _____
FEE n/c

FENCE PERMIT

GRAND JUNCTION PLANNING DEPARTMENT

BLDG ADDRESS: Riverside Park Trail
TAX SCHEDULE #: n/a
PROPERTY OWNER: City of G-J
PHONE: 244-1437
CONTRACTOR: J&S Fence & Taylor Fencing
PHONE: _____
MATERIAL: Chainlink / post & cable
HEIGHT: 6' Post = 4'

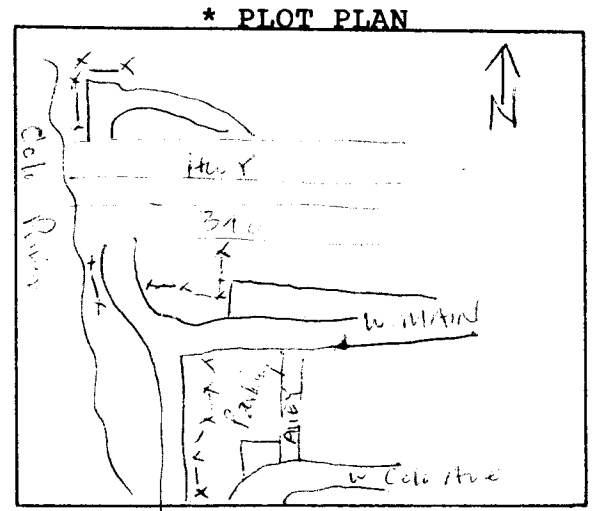

*Showing Property Line Dimensions, Easements, Streets, all Structures, and Setbacks from Property Lines.

FOR OFFICE USE ONLY

ZONE: PZ

SETBACKS: F n/a S _____ R _____

SPECIAL CONDITIONS: per plans

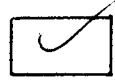

FINAL PERMIT

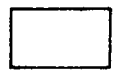

WILL REQUIRE SEPARATE PERMIT FROM THE CITY/COUNTY BUILDING DEPARTMENT.

ANY MODIFICATION TO THIS APPROVED FENCE PERMIT MUST BE APPROVED, IN WRITING, BY THIS DEPARTMENT.

I HEREBY ACKNOWLEDGE THAT I HAVE READ THIS APPLICATION AND THE ABOVE IS CORRECT, AND I AGREE TO COMPLY WITH THE REQUIREMENTS ABOVE. FAILURE TO COMPLY SHALL RESULT IN LEGAL ACTION.

[Signature]
SIGNATURE

APPROVED BY: Arnd Wetzel

DATE APPROVED: 4-7-89