

DATE SUBMITTED: 12/5/90

PERMIT # \_\_\_\_\_

FEE \$ 5.00

# FENCE PERMIT

GRAND JUNCTION PLANNING DEPARTMENT

BLDG ADDRESS: 1146 Hill

TAX SCHEDULE #: \_\_\_\_\_

PROPERTY OWNER: G.J. Fed. Credit Union

PHONE: 243-1370

CONTRACTOR: Greg Gador

PHONE: 241-5813

MATERIAL: Cedar fence

HEIGHT: 6'

\* PLOT PLAN

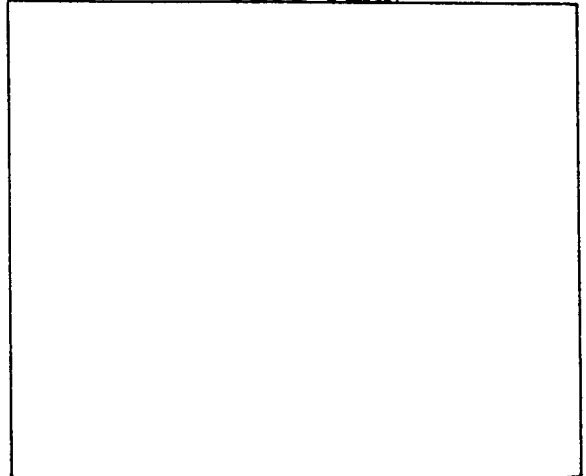

\*Showing Property Line Dimensions, Easements, Streets, all Structures, and Setbacks from Property Lines.

\*\*\*\*\*

### FOR OFFICE USE ONLY

ZONE: RSF-8

SETBACKS: F 20 S 5 R 15

SPECIAL CONDITIONS: \_\_\_\_\_



FINAL PERMIT



WILL REQUIRE SEPARATE PERMIT FROM THE CITY/COUNTY BUILDING DEPARTMENT.

\*\*\*\*\*

ANY MODIFICATION TO THIS APPROVED FENCE PERMIT MUST BE APPROVED, IN WRITING, BY THIS DEPARTMENT.

I HEREBY ACKNOWLEDGE THAT I HAVE READ THIS APPLICATION AND THE ABOVE IS CORRECT, AND I AGREE TO COMPLY WITH THE REQUIREMENTS ABOVE. FAILURE TO COMPLY SHALL RESULT IN LEGAL ACTION.

\_\_\_\_\_  
SIGNATURE

APPROVED BY: Valerie Louny

DATE APPROVED: 12-5-90

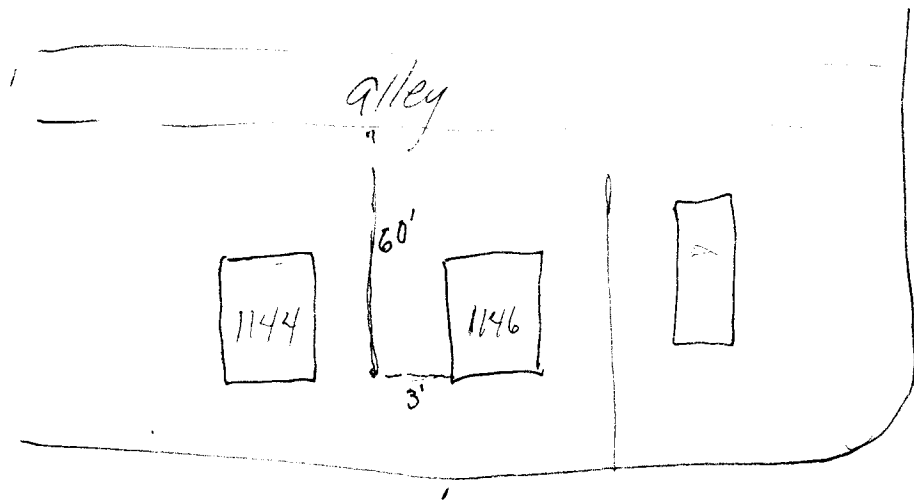

Hill

625<sup>th</sup>

313