

DATE SUBMITTED: 4-27-90

PERMIT # \_\_\_\_\_

FEE 5.00

# FENCE PERMIT

GRAND JUNCTION PLANNING DEPARTMENT

BLDG ADDRESS: 1220 Quay  
 TAX SCHEDULE #: 2945-132-09-010  
 PROPERTY OWNER: Mike Newman  
 PHONE: 541-9017  
 CONTRACTOR: J. S. Fence Co  
 PHONE: 243-2723  
 MATERIAL: Chain Link  
 HEIGHT: 60"

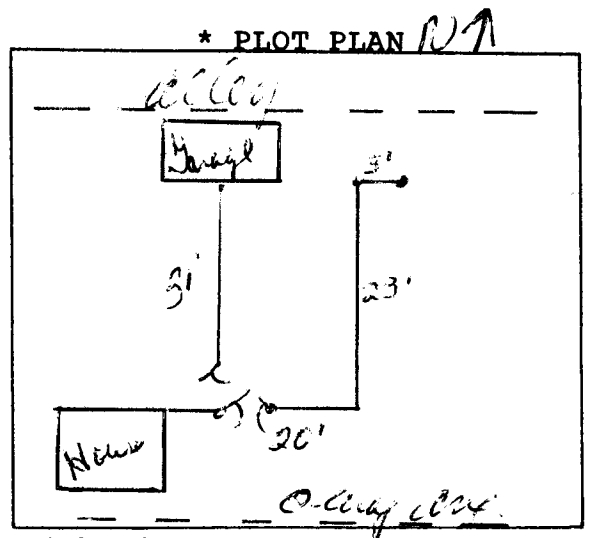

\*Showing Property Line Dimensions, Easements, Streets, all Structures, and Setbacks from Property Lines.

*Replacing existing fence.*

\*\*\*\*\*

**FOR OFFICE USE ONLY**

ZONE: RSF-5

SETBACKS: F 2' PL S PL R PL

SPECIAL CONDITIONS: \_\_\_\_\_

FINAL PERMIT

WILL REQUIRE SEPARATE PERMIT FROM THE CITY/COUNTY BUILDING DEPARTMENT.

\*\*\*\*\*

ANY MODIFICATION TO THIS APPROVED FENCE PERMIT MUST BE APPROVED, IN WRITING, BY THIS DEPARTMENT.

I HEREBY ACKNOWLEDGE THAT I HAVE READ THIS APPLICATION AND THE ABOVE IS CORRECT, AND I AGREE TO COMPLY WITH THE REQUIREMENTS ABOVE. FAILURE TO COMPLY SHALL RESULT IN LEGAL ACTION.

Chris Sessome  
SIGNATURE

APPROVED BY: B. Livingston

DATE APPROVED: 5/7/90