

DATE SUBMITTED: MARCH 15, 1990

PERMIT # _____

FEE \$ 500

FENCE PERMIT ✓

GRAND JUNCTION PLANNING DEPARTMENT

BLDG ADDRESS: 727 CHIPMETH AVE
 TAX SCHEDULE #: 2945-142-33-003
 PROPERTY OWNER: JAY + LUCILLE BARNETT
 PHONE: 303 242-1375
 CONTRACTOR: SELF
 PHONE: _____
 MATERIAL: CHAIN LINK
 HEIGHT: 4 FT

* PLOT PLAN

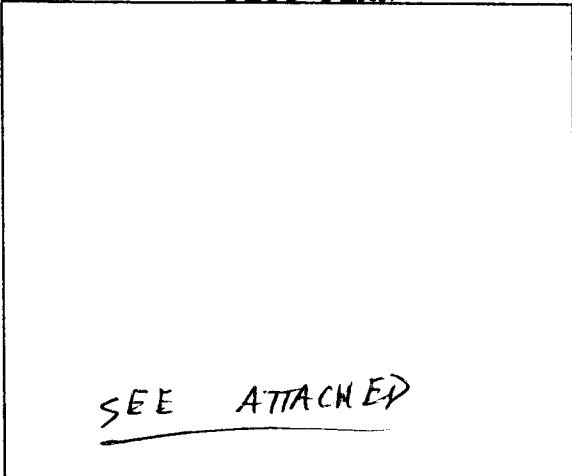

*Showing Property Line Dimensions, Easements, Streets, all Structures, and Setbacks from Property Lines.

FOR OFFICE USE ONLY

ZONE: RMF-6A

SETBACKS: F _____ S _____ R _____

SPECIAL CONDITIONS: _____

Fence on Property line

FINAL PERMIT

WILL REQUIRE SEPARATE PERMIT FROM THE CITY/COUNTY BUILDING DEPARTMENT.

ANY MODIFICATION TO THIS APPROVED FENCE PERMIT MUST BE APPROVED, IN WRITING, BY THIS DEPARTMENT.

I HEREBY ACKNOWLEDGE THAT I HAVE READ THIS APPLICATION AND THE ABOVE IS CORRECT, AND I AGREE TO COMPLY WITH THE REQUIREMENTS ABOVE. FAILURE TO COMPLY SHALL RESULT IN LEGAL ACTION.

Jay Barnett
SIGNATURE

APPROVED BY: [Signature]

DATE APPROVED: MARCH 15, 1990

5
BACK

ALLEY

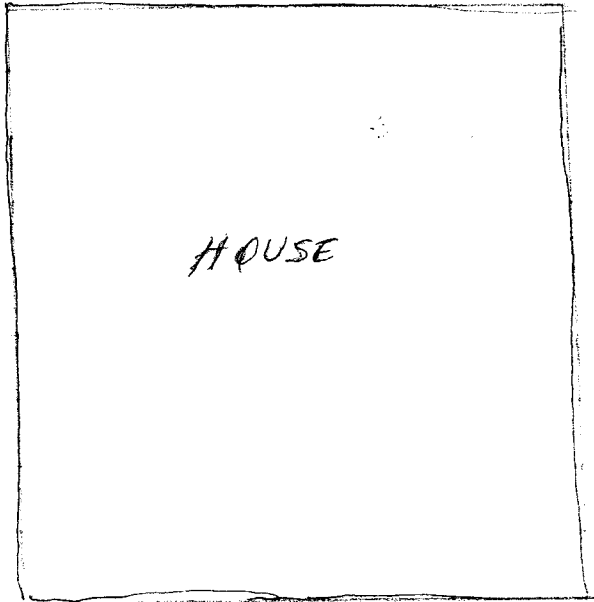
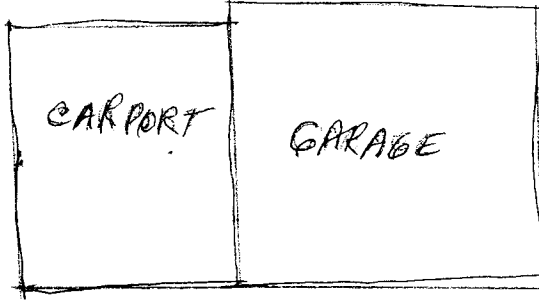

4' CHAIN
LINK FENCE

GATE
0/10

SIDEWALK

CHIPETA AVE
STREET

FRONT