

DATE SUBMITTED: 3/14/91

PERMIT # \_\_\_\_\_

FEE 5.00

# FENCE PERMIT

GRAND JUNCTION PLANNING DEPARTMENT

BLDG ADDRESS: 220 No 11<sup>th</sup>

TAX SCHEDULE #: 2845-144-12-010

PROPERTY OWNER: Vera Morse

PHONE: 245-0270

CONTRACTOR: \_\_\_\_\_

PHONE: \_\_\_\_\_

MATERIAL: woven wire

HEIGHT: 6'



\* PLOT PLAN

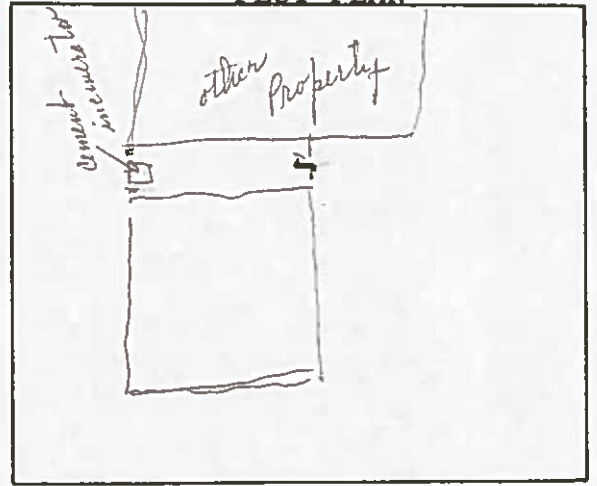

\*Showing Property Line Dimensions, Easements, Streets, all Structures, and Setbacks from Property Lines.

\*\*\*\*\*  
FOR OFFICE USE ONLY

ZONE: RMF-64

SETBACKS: F      S      R     

SPECIAL CONDITIONS: NONE

FINAL PERMIT

WILL REQUIRE SEPARATE PERMIT FROM THE CITY/COUNTY BUILDING DEPARTMENT.

\*\*\*\*\*

ANY MODIFICATION TO THIS APPROVED FENCE PERMIT MUST BE APPROVED, IN WRITING, BY THIS DEPARTMENT.

I HEREBY ACKNOWLEDGE THAT I HAVE READ THIS APPLICATION AND THE ABOVE IS CORRECT, AND I AGREE TO COMPLY WITH THE REQUIREMENTS ABOVE. FAILURE TO COMPLY SHALL RESULT IN LEGAL ACTION.

Vera W. Morse  
SIGNATURE

APPROVED BY: Karl G. Metzger

DATE APPROVED: 3/14/91