

DATE SUBMITTED: 11-7-91

PERMIT # _____

FEE \$15.00

FENCE PERMIT

GRAND JUNCTION PLANNING DEPARTMENT

BLDG ADDRESS: 526 1125th St
 TAX SCHEDULE #: 2945-131-11-013
 PROPERTY OWNER: Pete Beroni
 PHONE: 243-0153
 CONTRACTOR: J & J Fernaldo
 PHONE: 243-2723
 MATERIAL: Chain Link
 HEIGHT: 6'-w/ swing Straps

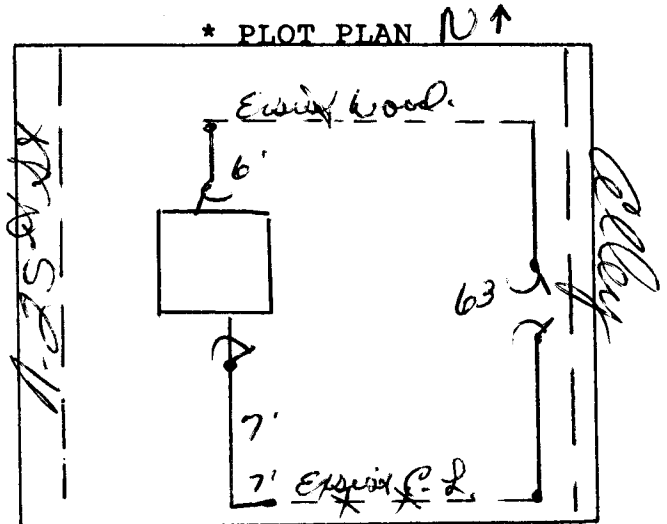

*Showing Property Line Dimensions, Easements, Streets, all Structures, and Setbacks from Property Lines.

 FOR OFFICE USE ONLY

ZONE: RSE

SETBACKS: F _____ S _____ R _____

SPECIAL CONDITIONS: _____

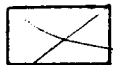

FINAL PERMIT



WILL REQUIRE SEPARATE PERMIT FROM THE CITY/COUNTY BUILDING DEPARTMENT.

 ANY MODIFICATION TO THIS APPROVED FENCE PERMIT MUST BE APPROVED, IN WRITING, BY THIS DEPARTMENT.

I HEREBY ACKNOWLEDGE THAT I HAVE READ THIS APPLICATION AND THE ABOVE IS CORRECT, AND I AGREE TO COMPLY WITH THE REQUIREMENTS ABOVE. FAILURE TO COMPLY SHALL RESULT IN LEGAL ACTION.

APPROVED BY: [Signature]

[Signature]
 SIGNATURE

DATE APPROVED: 11-15-91