

DATE SUBMITTED: May 6, 1991

PERMIT # _____

FEE 5.00

FENCE PERMIT

GRAND JUNCTION PLANNING DEPARTMENT

BLDG ADDRESS: 617 Teller Ave.
 TAX SCHEDULE #: 12945-42-18-003
 PROPERTY OWNER: Robt. W. Snyder
 PHONE: 344-2224
 CONTRACTOR: Self
 PHONE: Same as Above
 MATERIAL: Redwood or Cedar
 HEIGHT: 6 Foot

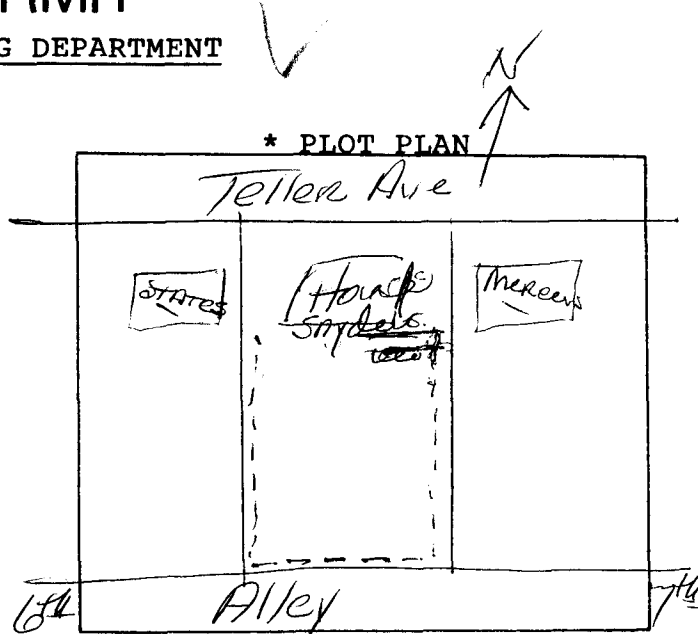

*Showing Property Line Dimensions, Easements, Streets, all Structures, and Setbacks from Property Lines.

 FOR OFFICE USE ONLY

ZONE: RME-32

SETBACKS: F / S / R /

SPECIAL CONDITIONS: _____

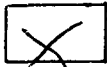

FINAL PERMIT



WILL REQUIRE SEPARATE PERMIT FROM THE CITY/COUNTY BUILDING DEPARTMENT.

ANY MODIFICATION TO THIS APPROVED FENCE PERMIT MUST BE APPROVED, IN WRITING, BY THIS DEPARTMENT.

I HEREBY ACKNOWLEDGE THAT I HAVE READ THIS APPLICATION AND THE ABOVE IS CORRECT, AND I AGREE TO COMPLY WITH THE REQUIREMENTS ABOVE. FAILURE TO COMPLY SHALL RESULT IN LEGAL ACTION.

Michelle Snyder
 SIGNATURE
 By: L.D. Green

APPROVED BY: K. Warner (OT)

DATE APPROVED: May 6, 1990