

DATE SUBMITTED: 6-4-91

PERMIT # _____

FEE 5.00

FENCE PERMIT

GRAND JUNCTION PLANNING DEPARTMENT

BLDG ADDRESS: 850 North Ave.

TAX SCHEDULE #: 2945-114-19-023

PROPERTY OWNER: _____

PHONE: 245-0898

CONTRACTOR: J&S Fence Co Inc

PHONE: 243-2723

MATERIAL: Wood-Cedar / Rod Iron

HEIGHT: 78"

Glenwood

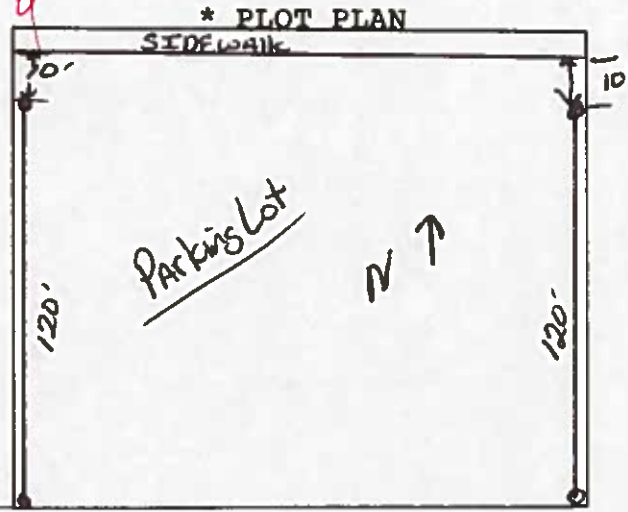

SEE File # 27-90

Taco Bell

Alley

*Showing Property Line Dimensions, Easements, Streets, all Structures, and Setbacks from Property Lines.

FOR OFFICE USE ONLY

ZONE: PB

SETBACKS: F _____ S _____ R _____

SPECIAL CONDITIONS: see Approved PLANS

FINAL PERMIT

WILL REQUIRE SEPARATE PERMIT FROM THE CITY/COUNTY BUILDING DEPARTMENT.

← NORTH Avenue →

ANY MODIFICATION TO THIS APPROVED FENCE PERMIT MUST BE APPROVED, IN WRITING, BY THIS DEPARTMENT.

I HEREBY ACKNOWLEDGE THAT I HAVE READ THIS APPLICATION AND THE ABOVE IS CORRECT, AND I AGREE TO COMPLY WITH THE REQUIREMENTS ABOVE. FAILURE TO COMPLY SHALL RESULT IN LEGAL ACTION.

APPROVED BY: [Signature]

[Signature]
SIGNATURE

DATE APPROVED: 6-3-91