

DATE SUBMITTED: 8/24/92

PERMIT # \_\_\_\_\_

FEE 5.00

# FENCE PERMIT

GRAND JUNCTION PLANNING DEPARTMENT

BLDG ADDRESS: 1302 Chipeta

TAX SCHEDULE #: 2945 132 07 008

PROPERTY OWNER: JOE PRINSTER

PHONE: 245 2659

CONTRACTOR: O Boyle & J. Kyle inc

PHONE: 245-5309

MATERIAL: Brick - recycled plastic

HEIGHT: 6'

\* PLOT PLAN

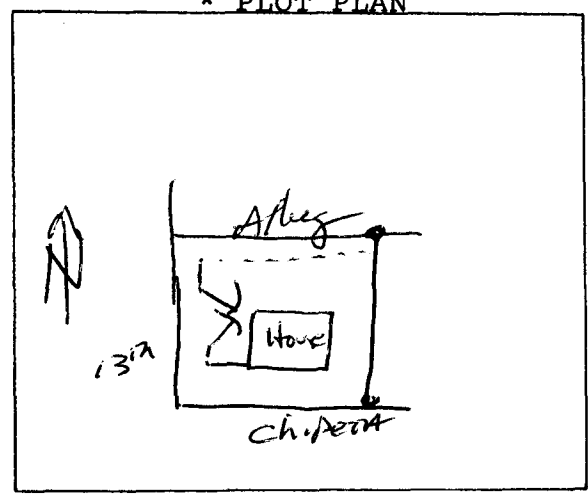

\*Showing Property Line Dimensions, Easements, Streets, all Structures, and Setbacks from Property Lines.

\*\*\*\*\*

### FOR OFFICE USE ONLY

ZONE: RSF-5

SETBACKS: F  S  R

SPECIAL CONDITIONS: \_\_\_\_\_

FINAL PERMIT

WILL REQUIRE SEPARATE PERMIT FROM THE CITY/COUNTY BUILDING DEPARTMENT.

\*\*\*\*\*

ANY MODIFICATION TO THIS APPROVED FENCE PERMIT MUST BE APPROVED, IN WRITING, BY THIS DEPARTMENT.

I HEREBY ACKNOWLEDGE THAT I HAVE READ THIS APPLICATION AND THE ABOVE IS CORRECT, AND I AGREE TO COMPLY WITH THE REQUIREMENTS ABOVE. FAILURE TO COMPLY SHALL RESULT IN LEGAL ACTION.

APPROVED BY: Shirley West

DATE APPROVED: 8-24-92

[Signature]  
SIGNATURE