

DATE SUBMITTED: 9/29/92

PERMIT # \_\_\_\_\_

FEE 5.00

# FENCE PERMIT

GRAND JUNCTION PLANNING DEPARTMENT

BLDG ADDRESS: 1350 North Ave.

TAX SCHEDULE #: 2945-123-21-001/014

PROPERTY OWNER: Steve Johnson

PHONE: 242-4297

CONTRACTOR: owner

PHONE: \_\_\_\_\_

MATERIAL: chain link

HEIGHT: 6'

\* PLOT PLAN

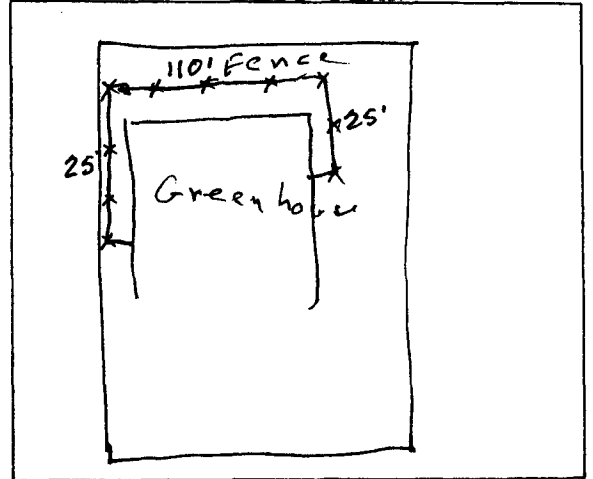

\*Showing Property Line Dimensions, Easements, Streets, all Structures, and Setbacks from Property Lines.

\*\*\*\*\*

### FOR OFFICE USE ONLY

ZONE: C1

SETBACKS: F \_\_\_\_\_ S \_\_\_\_\_ R \_\_\_\_\_

SPECIAL CONDITIONS: \_\_\_\_\_

\_\_\_\_\_

FINAL PERMIT

WILL REQUIRE SEPARATE PERMIT FROM THE CITY/COUNTY BUILDING DEPARTMENT.

\*\*\*\*\*

ANY MODIFICATION TO THIS APPROVED FENCE PERMIT MUST BE APPROVED, IN WRITING, BY THIS DEPARTMENT.

I HEREBY ACKNOWLEDGE THAT I HAVE READ THIS APPLICATION AND THE ABOVE IS CORRECT, AND I AGREE TO COMPLY WITH THE REQUIREMENTS ABOVE. FAILURE TO COMPLY SHALL RESULT IN LEGAL ACTION.

Steve Johnson  
SIGNATURE

APPROVED BY: Angeline Barrett

DATE APPROVED: 9/29/92