

Receipt # 241

DATE SUBMITTED: 4/26/93

PERMIT # \_\_\_\_\_  
FEE \_\_\_\_\_

# FENCE PERMIT

GRAND JUNCTION PLANNING DEPARTMENT

BLDG ADDRESS: 1520 N. 7th ST.  
TAX SCHEDULE #: 2445-114-13-0002  
PROPERTY OWNER: PIERRE ROUZIER  
PHONE: 241-2186  
CONTRACTOR: \_\_\_\_\_  
PHONE: \_\_\_\_\_  
MATERIAL: Sp. Pine wood  
HEIGHT: 3 1/2' A

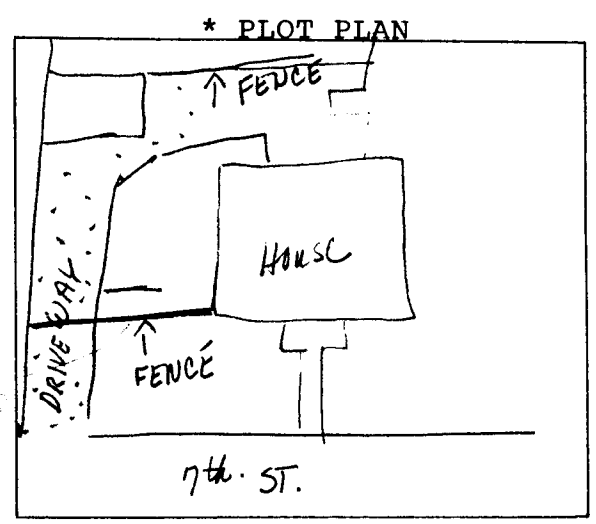

\*Showing Property Line Dimensions, Easements, Streets, all Structures, and Setbacks from Property Lines.

4' CHAIN LINK IN BACK

\*\*\*\*\*

### FOR OFFICE USE ONLY

ZONE: TME SC

SETBACKS: F \_\_\_\_\_ S \_\_\_\_\_ R \_\_\_\_\_

SPECIAL CONDITIONS: \_\_\_\_\_

FINAL PERMIT

WILL REQUIRE SEPARATE PERMIT FROM THE CITY/COUNTY BUILDING DEPARTMENT.

\*\*\*\*\*

ANY MODIFICATION TO THIS APPROVED FENCE PERMIT MUST BE APPROVED, IN WRITING, BY THIS DEPARTMENT.

I HEREBY ACKNOWLEDGE THAT I HAVE READ THIS APPLICATION AND THE ABOVE IS CORRECT, AND I AGREE TO COMPLY WITH THE REQUIREMENTS ABOVE. FAILURE TO COMPLY SHALL RESULT IN LEGAL ACTION.

Pierre Rouzier  
SIGNATURE

APPROVED BY: \_\_\_\_\_

DATE APPROVED: 4-26-93