

DATE SUBMITTED: 4-28-92

PERMIT # _____

FEE 5.00

FENCE PERMIT

GRAND JUNCTION PLANNING DEPARTMENT

BLDG ADDRESS: 554 28 Rd

TAX SCHEDULE #: 2943-073-10-007

PROPERTY OWNER: Dan Seymour

PHONE: 245-3084

CONTRACTOR: J & S Fence Co. Inc.

PHONE: 243-2723

MATERIAL: Wood

HEIGHT: 6'

28 Rd.

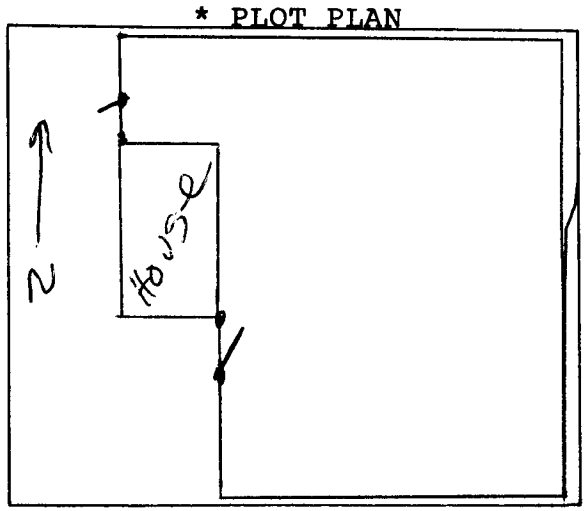

*Showing Property Line Dimensions, Easements, Streets, all Structures, and Setbacks from Property Lines.

FOR OFFICE USE ONLY

ZONE: RSF-8

SETBACKS: F 20' S PL R PL

SPECIAL CONDITIONS: Fence must be 20ft from front Property Line

FINAL PERMIT

WILL REQUIRE SEPARATE PERMIT FROM THE CITY/COUNTY BUILDING DEPARTMENT.

ANY MODIFICATION TO THIS APPROVED FENCE PERMIT MUST BE APPROVED, IN WRITING, BY THIS DEPARTMENT.

I HEREBY ACKNOWLEDGE THAT I HAVE READ THIS APPLICATION AND THE ABOVE IS CORRECT, AND I AGREE TO COMPLY WITH THE REQUIREMENTS ABOVE. FAILURE TO COMPLY SHALL RESULT IN LEGAL ACTION.

Chris Seymour
SIGNATURE

APPROVED BY: B. Paulson

DATE APPROVED: 4/28/92