

DATE SUBMITTED: 6-11-92

PERMIT # _____

FEE 5.00

FENCE PERMIT

GRAND JUNCTION PLANNING DEPARTMENT

BLDG ADDRESS: 603 26 3/4 Rd

TAX SCHEDULE #: 293-02419-001

PROPERTY OWNER: James Lester

PHONE: 245-9296

CONTRACTOR: J.S. Fence Co. Inc.

PHONE: 243-2723

MATERIAL: 72" Cedar

HEIGHT: 72" & 48"

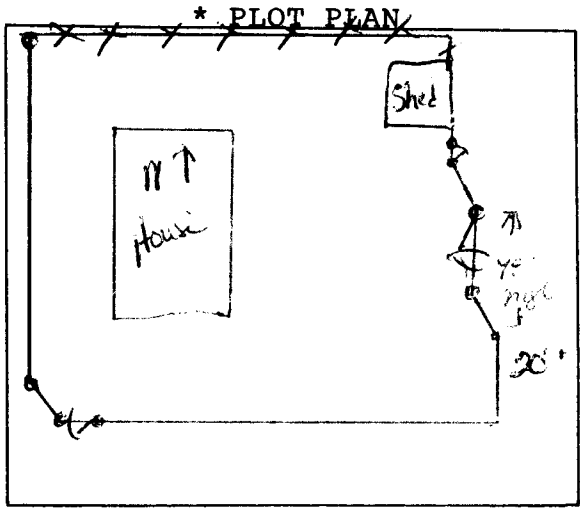

*Showing Property Line Dimensions, Easements, Streets, all Structures, and Setbacks from Property Lines.

FOR OFFICE USE ONLY

ZONE: R SF - 4

SETBACKS: F 20 ^{from property line} S 3 R 10

SPECIAL CONDITIONS: _____

FINAL PERMIT

WILL REQUIRE SEPARATE PERMIT FROM THE CITY/COUNTY BUILDING DEPARTMENT.

ANY MODIFICATION TO THIS APPROVED FENCE PERMIT MUST BE APPROVED, IN WRITING, BY THIS DEPARTMENT.

I HEREBY ACKNOWLEDGE THAT I HAVE READ THIS APPLICATION AND THE ABOVE IS CORRECT, AND I AGREE TO COMPLY WITH THE REQUIREMENTS ABOVE. FAILURE TO COMPLY SHALL RESULT IN LEGAL ACTION.

Howard Tan

SIGNATURE

APPROVED BY: Angeline Barrett

DATE APPROVED: 6/11/92