

DATE SUBMITTED: 6/11/92

PERMIT # _____

FEE \$5.00

FENCE PERMIT

GRAND JUNCTION PLANNING DEPARTMENT

BLDG ADDRESS: 640 N. 7th St.

TAX SCHEDULE #: 2345-141-26-015

PROPERTY OWNER: Mary M. Coleman

PHONE: 242-5298

CONTRACTOR: Melvin Jones (Prof. Contr.)

PHONE: 874-3462

MATERIAL: Cedar

HEIGHT: 6'

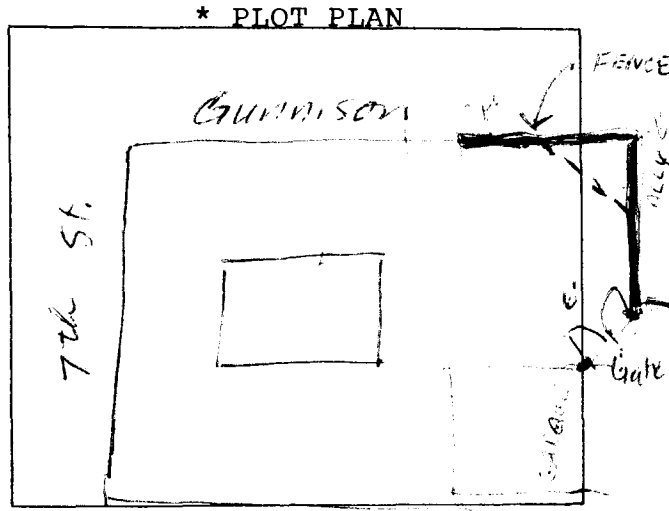

*Showing Property Line Dimensions, Easements, Streets, all Structures, and Setbacks from Property Lines.

FOR OFFICE USE ONLY

ZONE: RR B

SETBACKS: F 20' ^{from property line} S 3 R 3

SPECIAL CONDITIONS: _____

FINAL PERMIT

WILL REQUIRE SEPARATE PERMIT FROM THE CITY/COUNTY BUILDING DEPARTMENT.

ANY MODIFICATION TO THIS APPROVED FENCE PERMIT MUST BE APPROVED, IN WRITING, BY THIS DEPARTMENT.

I HEREBY ACKNOWLEDGE THAT I HAVE READ THIS APPLICATION AND THE ABOVE IS CORRECT, AND I AGREE TO COMPLY WITH THE REQUIREMENTS ABOVE. FAILURE TO COMPLY SHALL RESULT IN LEGAL ACTION.

Melvin Jones
SIGNATURE

APPROVED BY: Angeline Barrett

DATE APPROVED: 6/11/92