

DATE SUBMITTED: 6-29-93

PERMIT # \_\_\_\_\_  
FEE \$500

# FENCE PERMIT

GRAND JUNCTION PLANNING DEPARTMENT

BLDG ADDRESS: 1135 Chipeta  
TAX SCHEDULE #: 2945-141-31-005  
PROPERTY OWNER: R D Clare  
PHONE: 241-1745  
CONTRACTOR: self  
PHONE: 241-1745  
MATERIAL: Wood / Chain link  
HEIGHT: 6' / 48"

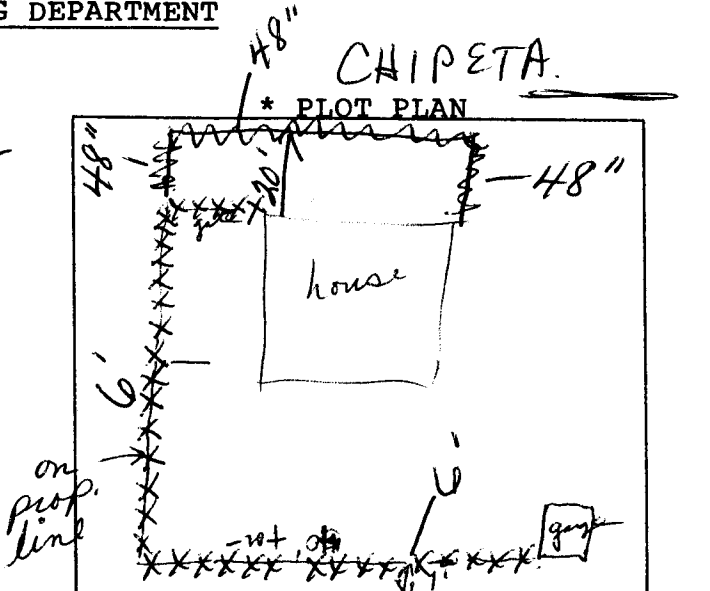

Replacing Existing  
X

\*Showing Property Line Dimensions, Easements, Streets, all Structures, and Setbacks from Property Lines.

ALLEY

\*\*\*\*\*

### FOR OFFICE USE ONLY

ZONE: RSF-8

SETBACKS: F 20' S 0 R 0

SPECIAL CONDITIONS: \_\_\_\_\_

FINAL PERMIT

WILL REQUIRE SEPARATE PERMIT FROM THE CITY/COUNTY BUILDING DEPARTMENT.

\*\*\*\*\*

ANY MODIFICATION TO THIS APPROVED FENCE PERMIT MUST BE APPROVED, IN WRITING, BY THIS DEPARTMENT.

I HEREBY ACKNOWLEDGE THAT I HAVE READ THIS APPLICATION AND THE ABOVE IS CORRECT, AND I AGREE TO COMPLY WITH THE REQUIREMENTS ABOVE. FAILURE TO COMPLY SHALL RESULT IN LEGAL ACTION.

R D Clare  
SIGNATURE

APPROVED BY: Marcia Petty

DATE APPROVED: 6/29/93