

DATE SUBMITTED: 9/13/93

PERMIT # _____

FEE 5.00

FENCE PERMIT

GRAND JUNCTION PLANNING DEPARTMENT

BLDG ADDRESS: 1455 Chipeta Ave
 TAX SCHEDULE #: 2945-132-11-006
 PROPERTY OWNER: JAMES HAMMOND
 PHONE: 241-0108
 CONTRACTOR: Self
 PHONE: SAME
 MATERIAL: wood & chain link
 HEIGHT: 4'

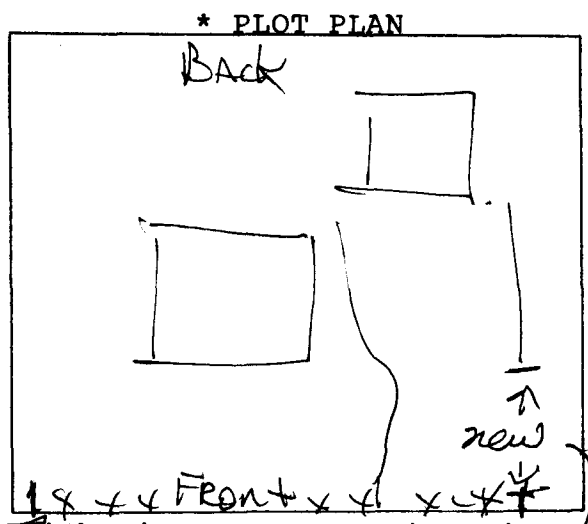

*Showing Property Line Dimensions, Easements, Streets, all Structures, and Setbacks from Property Lines.

FOR OFFICE USE ONLY

ZONE: RSF-8

SETBACKS: F S R

SPECIAL CONDITIONS: _____

FINAL PERMIT

WILL REQUIRE SEPARATE PERMIT FROM THE CITY/COUNTY BUILDING DEPARTMENT.

ANY MODIFICATION TO THIS APPROVED FENCE PERMIT MUST BE APPROVED, IN WRITING, BY THIS DEPARTMENT.

I HEREBY ACKNOWLEDGE THAT I HAVE READ THIS APPLICATION AND THE ABOVE IS CORRECT, AND I AGREE TO COMPLY WITH THE REQUIREMENTS ABOVE. FAILURE TO COMPLY SHALL RESULT IN LEGAL ACTION.

APPROVED BY: [Signature]

DATE APPROVED: 9/13/93

James Hammond
SIGNATURE