

DATE SUBMITTED: 3/12/93

PERMIT # _____
FEE \$5.00

FENCE PERMIT

GRAND JUNCTION PLANNING DEPARTMENT

BLDG ADDRESS: 1638 N 7th

TAX SCHEDULE #: 2945-114-00-012

PROPERTY OWNER: Tom Wilkerson

PHONE: _____

CONTRACTOR: Marmatha Fence

PHONE: 241 9303

MATERIAL: 6' Cedar & 4' Chain link

HEIGHT: 6' ↑ 4' 9"

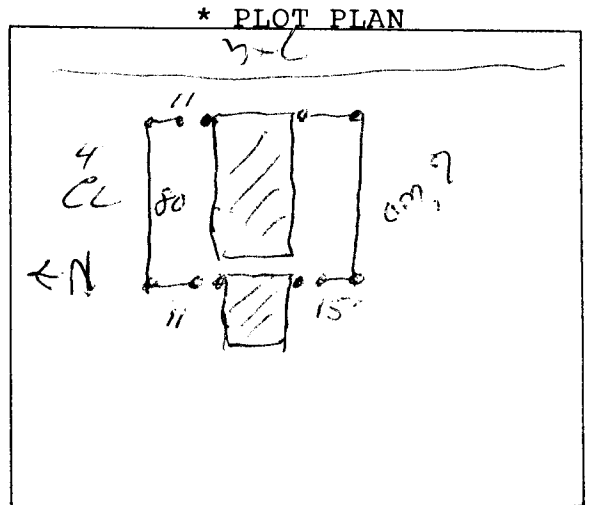

*Showing Property Line Dimensions, Easements, Streets, all Structures, and Setbacks from Property Lines.

FOR OFFICE USE ONLY

ZONE: RMF-32

SETBACKS: F property line S _____ R _____

SPECIAL CONDITIONS: _____

FINAL PERMIT

WILL REQUIRE SEPARATE PERMIT FROM THE CITY/COUNTY BUILDING DEPARTMENT.

ANY MODIFICATION TO THIS APPROVED FENCE PERMIT MUST BE APPROVED, IN WRITING, BY THIS DEPARTMENT.

I HEREBY ACKNOWLEDGE THAT I HAVE READ THIS APPLICATION AND THE ABOVE IS CORRECT, AND I AGREE TO COMPLY WITH THE REQUIREMENTS ABOVE. FAILURE TO COMPLY SHALL RESULT IN LEGAL ACTION.

[Signature]

SIGNATURE

APPROVED BY: Kathy Porter

DATE APPROVED: 3/12/93