

FEE ~~10~~.00

FENCE PERMIT
GRAND JUNCTION COMMUNITY DEVELOPMENT DEPARTMENT

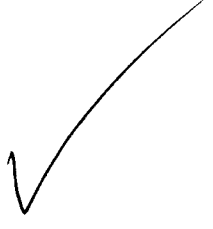

THIS SECTION TO BE COMPLETED BY APPLICANT

PLOT PLAN

PROPERTY ADDRESS 2671 Hemlock Ct.
TAX SCHEDULE NO 2701-354-54-011
PROPERTY OWNER Stern
OWNER'S PHONE 245-4612
OWNER'S ADDRESS 2671 Hemlock Ct.
CONTRACTOR Stern
CONTRACTOR'S PHONE _____
FENCE MATERIAL Cedar Picket Fence
FENCE HEIGHT 6'

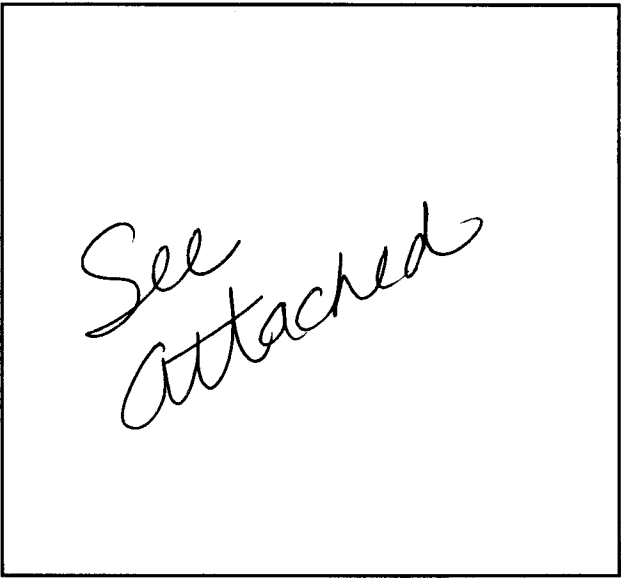

Plot plan must show property lines and property dimensions, all easements, all rights-of-way, all structures, all setbacks from property lines, & fence height(s).

THIS SECTION TO BE COMPLETED BY COMMUNITY DEVELOPMENT DEPARTMENT STAFF

ZONE PR
SPECIAL CONDITIONS _____

SETBACKS: Front _____ from property line (PL) or
_____ from center of ROW, whichever is greater.
Side _____ from PL Rear _____ from PL

Fences exceeding six feet in height require a separate permit from the City/County Building Department. A fence constructed on a corner lot that extends past the rear of the house along the side yard or abuts an alley requires approval from the City Engineer (Section 5-5-5B of the Grand Junction Zoning and Development Code).

The owner/applicant must correctly identify all property lines, easements, and rights-of-way and ensure the fence is located within the property's boundaries. Covenants, conditions, restrictions, easements and/or rights-of-way may restrict or prohibit the placement of fence(s). The owner/applicant is responsible for compliance with covenants, conditions, and restrictions which may apply. Fences built in easements may be subject to removal at the property owner's sole and absolute expense. Any modification of design and/or material as approved in this fence permit must be approved, in writing, by the Community Development Department Director.

I hereby acknowledge that I have read this application and the information and plot plan are correct; I agree to comply with any and all codes, ordinances, laws, regulations, or restrictions which apply.

I understand that failure to comply shall result in legal action, which may include but not necessarily be limited to removal of the fence(s) at the owner's cost.

Applicant's Signature Kathy Stern Date Aug 15, 1995
Community Development's Approval Marcia Rabideaux Date 8-15-95
City Engineer's Approval (if required) _____ Date _____

VALID FOR SIX MONTHS FROM DATE OF ISSUANCE (Section 9-3-2D Grand Junction Zoning & Development Code)

(White: Community Development) (Yellow: Code Enforcement) (Pink: Customer)

6" Solid Wood

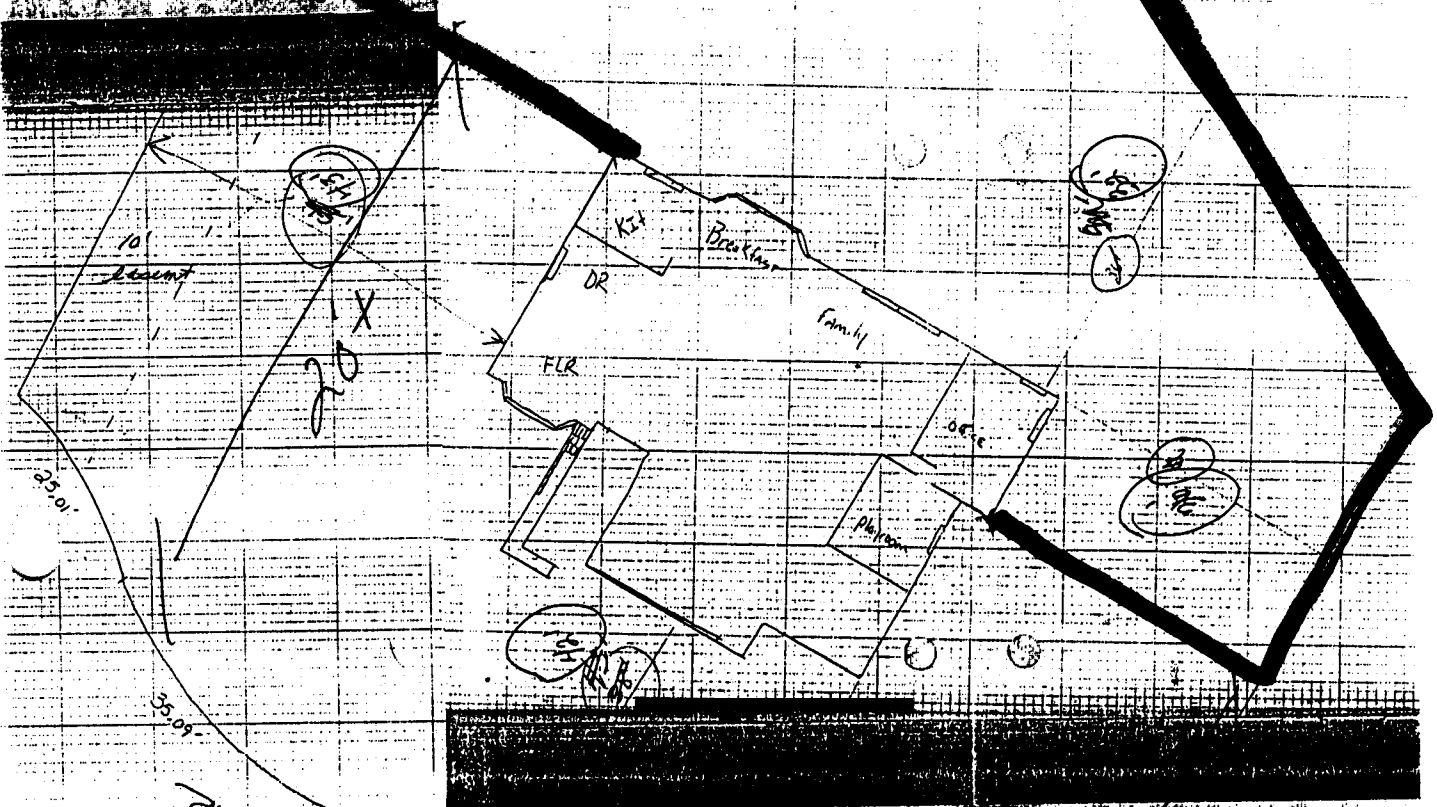

Chgd location of house 8-24-95
 8-28-95 ME

2671
 2841
 1792
 56/2/95
 2841
 1792
 2671

Compass Edging
 AND PROPERTY LINES

1792