

FEE \$10.00

PERMIT # 10172

FENCE PERMIT

GRAND JUNCTION COMMUNITY DEVELOPMENT DEPARTMENT

THIS SECTION TO BE COMPLETED BY APPLICANT

PLOT PLAN

PROPERTY ADDRESS 296 1/2 Mountain View St

TAX SCHEDULE NO 2945-251-00-045

PROPERTY OWNER Shane + Shauna Christensen

OWNER'S PHONE (970) 255-0328

OWNER'S ADDRESS 296 1/2 Mountain View St

CONTRACTOR self

CONTRACTOR'S PHONE _____

FENCE MATERIAL wood

FENCE HEIGHT 6 Ft. to front of house
+ 30" solid remaining
20' ±

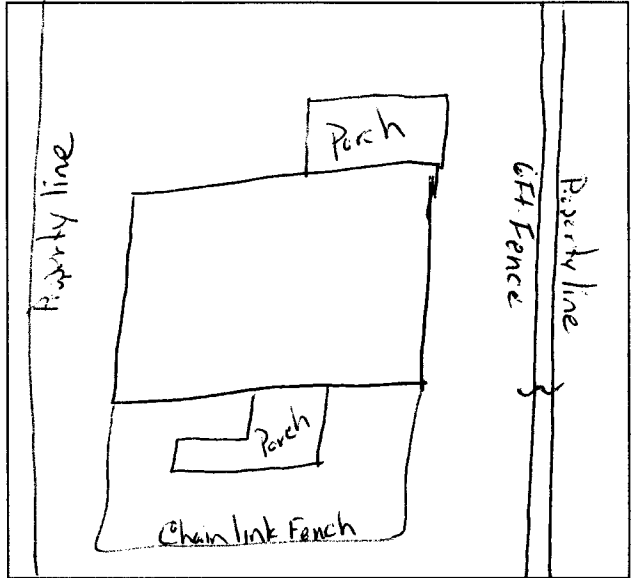

Plot plan must show property lines and property dimensions, all easements, all rights-of-way, all structures, all setbacks from property lines, & fence height(s).

THIS SECTION TO BE COMPLETED BY COMMUNITY DEVELOPMENT DEPARTMENT STAFF

ZONE RSF-8

SETBACKS: Front 20' for 6' solid from property line (PL) or _____ from center of ROW, whichever is greater.
Side Ø from PL Rear Ø from PL

SPECIAL CONDITIONS _____

Fences exceeding six feet in height require a separate permit from the City/County Building Department. A fence constructed on a corner lot that extends past the rear of the house along the side yard or abuts an alley requires approval from the City Engineer (Section 5-5-5B of the Grand Junction Zoning and Development Code).

The owner/applicant must correctly identify all property lines, easements, and rights-of-way and ensure the fence is located within the property's boundaries. Covenants, conditions, restrictions, easements and/or rights-of-way may restrict or prohibit the placement of fence(s). The owner/applicant is responsible for compliance with covenants, conditions, and restrictions which may apply. Fences built in easements may be subject to removal at the property owner's sole and absolute expense. Any modification of design and/or material as approved in this fence permit must be approved, in writing, by the Community Development Department Director.

I hereby acknowledge that I have read this application and the information and plot plan are correct; I agree to comply with any and all codes, ordinances, laws, regulations, or restrictions which apply.

I understand that failure to comply shall result in legal action, which may include but not necessarily be limited to removal of the fence(s) at the owner's cost.

Applicant's Signature Shauna Christensen

Date Nov 17, 1997

Community Development's Approval Gonnie Edwards

Date 11/17/97

City Engineer's Approval (if required) N/A

Date _____

VALID FOR SIX MONTHS FROM DATE OF ISSUANCE (Section 9-3-2D Grand Junction Zoning & Development Code)

(White: Community Development)

(Yellow: Code Enforcement)

(Pink: Customer)