

FEE \$10.00

PERMIT # 10053

FENCE PERMIT

GRAND JUNCTION COMMUNITY DEVELOPMENT DEPARTMENT

THIS SECTION TO BE COMPLETED BY APPLICANT

PLOT PLAN

PROPERTY ADDRESS 632 E PAGOSA DR
 TAX SCHEDULE NO 2743-063-22-001
 PROPERTY OWNER Shiou Kwan
 OWNER'S PHONE 242-2477 (Sally Courme 245-8988 243-3118)
 OWNER'S ADDRESS 632 E PAGOSA DR
 CONTRACTOR Western Slope Services Inc
 CONTRACTOR'S PHONE 241-1034 (Bill Fox)
 FENCE MATERIAL Cedar
 FENCE HEIGHT 6 ft

See Attached

Plot plan must show property lines and property dimensions, all easements, all rights-of-way, all structures, all setbacks from property lines, & fence height(s).

THIS SECTION TO BE COMPLETED BY COMMUNITY DEVELOPMENT DEPARTMENT STAFF

ZONE RSF-5
 SPECIAL CONDITIONS _____

SETBACKS: Front 20' from property line (PL) or
45' from center of ROW, whichever is greater.
 Side _____ from PL Rear _____ from PL

Fences exceeding six feet in height require a separate permit from the City/County Building Department. A fence constructed on a corner lot that extends past the rear of the house along the side yard or abuts an alley requires approval from the City Engineer (Section 5-5-5B of the Grand Junction Zoning and Development Code).

The owner/applicant must correctly identify all property lines, easements, and rights-of-way and ensure the fence is located within the property's boundaries. Covenants, conditions, restrictions, easements and/or rights-of-way may restrict or prohibit the placement of fence(s). The owner/applicant is responsible for compliance with covenants, conditions, and restrictions which may apply. Fences built in easements may be subject to removal at the property owner's sole and absolute expense. Any modification of design and/or material as approved in this fence permit must be approved, in writing, by the Community Development Department Director.

I hereby acknowledge that I have read this application and the information and plot plan are correct; I agree to comply with any and all codes, ordinances, laws, regulations, or restrictions which apply.

I understand that failure to comply shall result in legal action, which may include but not necessarily be limited to removal of the fence(s) at the owner's cost.

Applicant's Signature [Signature]
 Community Development's Approval [Signature]
 City Engineer's Approval (if required) _____

Date 6/23/97
 Date 6/23/97
 Date _____

VALID FOR SIX MONTHS FROM DATE OF ISSUANCE (Section 9-3-2D Grand Junction Zoning & Development Code)

(White: Community Development) (Yellow: Code Enforcement) (Pink: Customer)

Proposal



FENCING

796 24th Road • Grand Junction, CO 81505
(970) 241-1034 • (970) 260-0325 Cellular

PROPOSAL SUBMITTED TO SHIOW KWAN 2422477	TYPE FENCING 6 FT CEDAR	FOOTAGE 110 FT
STREET 632 E PAGOSA DRIVE		
CITY, STATE AND ZIP CODE GRAND JUNCTION COLO		ESTER
PHONE NO. SALLY GAURMAR 243-3118 245-8988	DATE OF BID 6-20-97	LOCATION # 221040

We hereby submit specifications and estimates for:

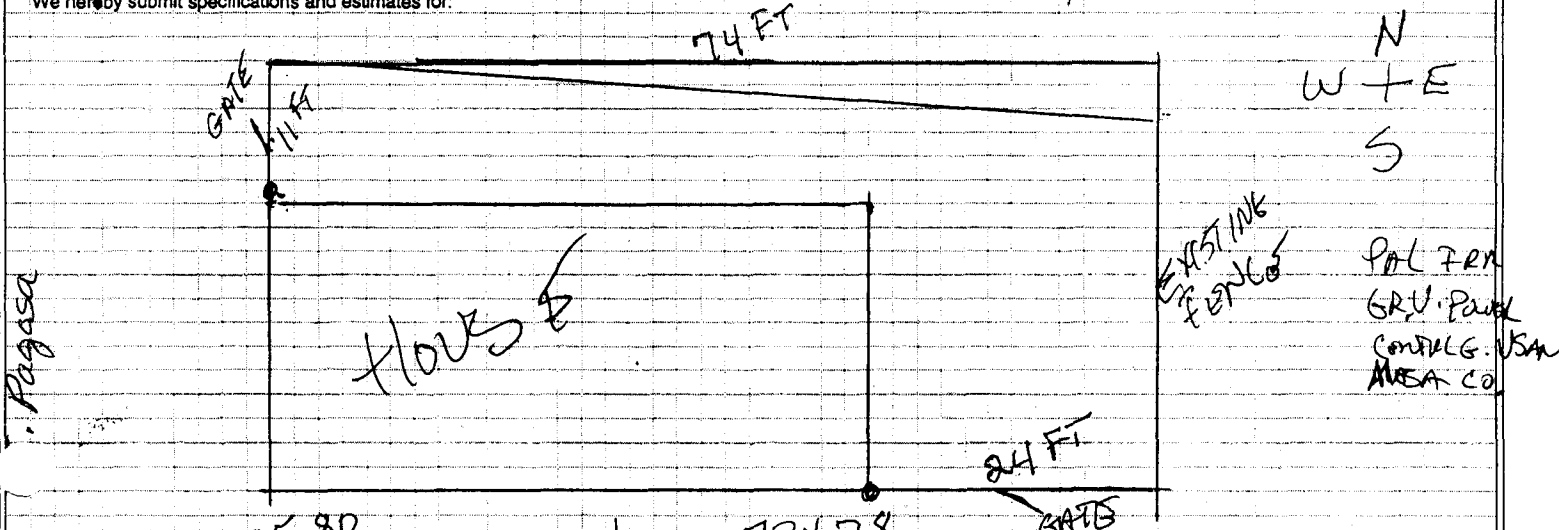

20 POSTS - 185.80 20 BAGS - 57.80 60 2x4s - 294.00 2 GATES - 100.00 6 HINGLES - 17.40 2 LATCH NAILS - 19.78 60.00 <hr/> 734.78	MATLS = 734.78 TAX = 55.11 PERMIT = 10.00 LABOR = 900.00 <hr/> 1699.89
---	--

Hawthorne

We are not responsible for placement of fence lines, underground wiring or water lines.

We Propose hereby to furnish material and labor - complete in accordance with the above specifications, for the sum of:

JOB TO START 6-25-97 MATLS, TAX + PERMIT dollars (\$ 799.89).

Payment to be made as follows:

TO BE PAID AT START OF JOB! \$900.00 LABOR TO BE PAID AT JOB COMPLETION 6-28-97

All material is guaranteed to be as specified. All work to be completed in a workmanlike manner according to standard practices. Any alteration or deviation from above specifications involving extra costs will be executed only upon written orders, and will become an extra charge over and above the estimate. All agreements contingent upon strikes, accidents or delays beyond our control. Owner to carry fire, tornado and other necessary insurance. All workers are fully covered by Workmen's Compensation Insurance.

Authorized Signature: *[Signature]*
 Note: This proposal may be withdrawn by us if not accepted within 10 days.

Acceptance of Proposal - The above prices, specifications and conditions are satisfactory and hereby accepted. You are authorized to do the work as specified. Payment will be made as outlined above.

Signature _____
 Signature _____

Date of Acceptance: _____