

FEE \$10.00

PERMIT # 10353

FENCE PERMIT
GRAND JUNCTION COMMUNITY DEVELOPMENT DEPARTMENT

THIS SECTION TO BE COMPLETED BY APPLICANT

PLOT PLAN

PROPERTY ADDRESS 5695 Westgate Drive
TAX SCHEDULE NO 2945-202-22-015
PROPERTY OWNER Wilco Inc
OWNER'S PHONE 245-3869
OWNER'S ADDRESS 569 Westgate Drive
CONTRACTOR Taylor Fence
CONTRACTOR'S PHONE 241-1473
FENCE MATERIAL 6' CC Temp Fence
FENCE HEIGHT 6' Tall

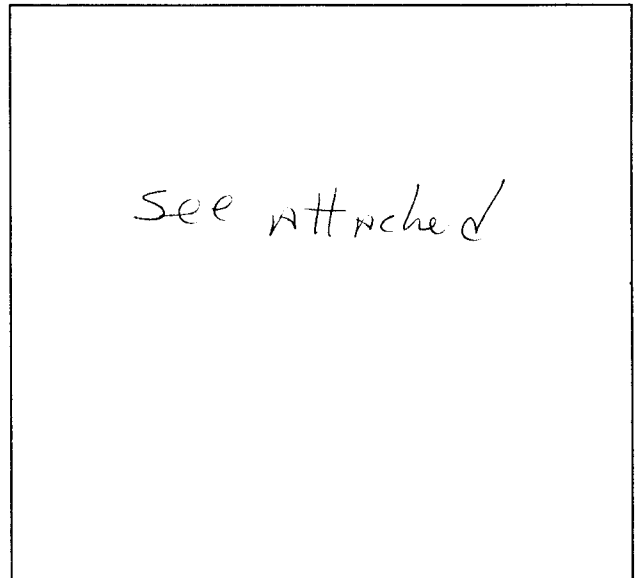

Plot plan must show property lines and property dimensions, all easements, all rights-of-way, all structures, all setbacks from property lines, & fence height(s).

THIS SECTION TO BE COMPLETED BY COMMUNITY DEVELOPMENT DEPARTMENT STAFF

ZONE C-2
SPECIAL CONDITIONS

SETBACKS: Front from property line (PL) or from center of ROW, whichever is greater.
Side from PL Rear from PL

Fences exceeding six feet in height require a separate permit from the City/County Building Department. A fence constructed on a corner lot that extends past the rear of the house along the side yard or abuts an alley requires approval from the City Engineer (Section 5-5-5B of the Grand Junction Zoning and Development Code).

The owner/applicant must correctly identify all property lines, easements, and rights-of-way and ensure the fence is located within the property's boundaries. Covenants, conditions, restrictions, easements and/or rights-of-way may restrict or prohibit the placement of fence(s). The owner/applicant is responsible for compliance with covenants, conditions, and restrictions which may apply. Fences built in easements may be subject to removal at the property owner's sole and absolute expense. Any modification of design and/or material as approved in this fence permit must be approved, in writing, by the Community Development Department Director.

I hereby acknowledge that I have read this application and the information and plot plan are correct; I agree to comply with any and all codes, ordinances, laws, regulations, or restrictions which apply.

I understand that failure to comply shall result in legal action, which may include but not necessarily be limited to removal of the fence(s) at the owner's cost.

Applicant's Signature Jerry Orman
Community Development's Approval Anita Costello
City Engineer's Approval (if required)

Date 12-2-98
Date 12-2-98
Date

VALID FOR SIX MONTHS FROM DATE OF ISSUANCE (Section 9-3-2D Grand Junction Zoning & Development Code)

(White: Community Development) (Yellow: Code Enforcement) (Pink: Customer)

WORK ORDER  
**TAYLOR FENCE COMPANY**

TO Coppersmith Plumbing & Air Conditioning  
569 Westgate Drive South  
off 25th go South to Pinyan Ave

DATE 11/2/89 **W**  
 PHONE 245-3869  
 CUSTOMER'S ORDER NO. \_\_\_\_\_  
 SALESMAN ZG

TERMS \_\_\_\_\_

QUANTITY	DESCRIPTION	PRICE
100'	6'x 1 1/2" ss c/l or 2nd's	
2	3'x 8' ss40	
1	2 3/4' x 8' ss40 corner	
10	8' Tap post	
2	2 3/4' x 8' ss40 End	
1	4'x6' walk Gate = use rejected Gate if possible	
1	20'x6' Double Drive = "use dog Run panels" w/ chain for	
NOTES:		
1) possible 1-Trip		
2) Const. Fence		

HAND DRAWN

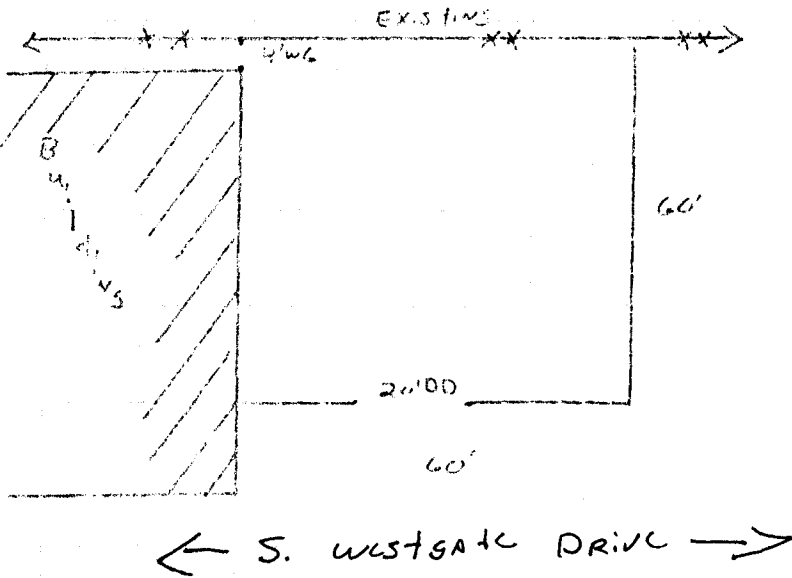

Material	640
Tax	50
Labour	350
Total	1040