

FEE \$10.00

PERMIT # 10484

FENCE PERMIT

GRAND JUNCTION COMMUNITY DEVELOPMENT DEPARTMENT

THIS SECTION TO BE COMPLETED BY APPLICANT

PLOT PLAN

PROPERTY ADDRESS 2372 RANA RD

TAX SCHEDULE NO 2945-174-29-005

PROPERTY OWNER ADAM C LEVINSON

OWNER'S PHONE 970-255-0533

OWNER'S ADDRESS SAME AS ABOVE
ADAM LEVINSON

CONTRACTOR [REDACTED]

CONTRACTOR'S PHONE SAME AS ABOVE

FENCE MATERIAL CEDAR

FENCE HEIGHT 6'

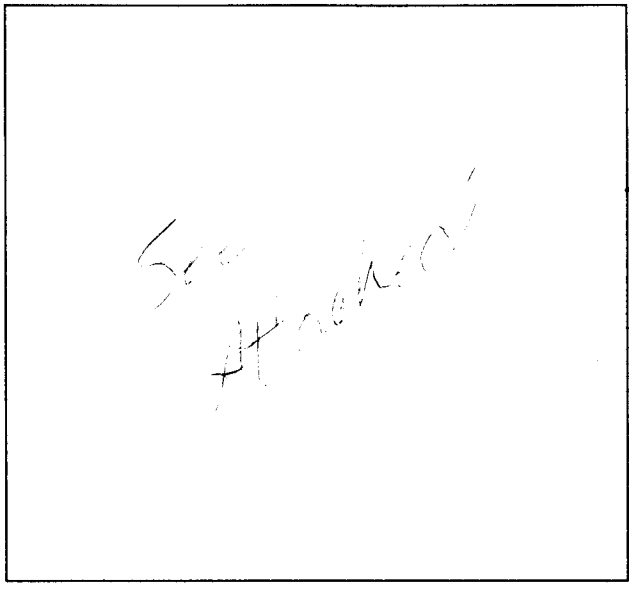

Plot plan must show property lines and property dimensions, all easements, all rights-of-way, all structures, all setbacks from property lines, & fence height(s).

THIS SECTION TO BE COMPLETED BY COMMUNITY DEVELOPMENT DEPARTMENT STAFF

ZONE R-4

SPECIAL CONDITIONS ACCO appr. req'd

SETBACKS: Front 20' from property line (PL) or _____ from center of ROW, whichever is greater.

Side _____ from PL Rear _____ from PL

Fences exceeding six feet in height require a separate permit from the City/County Building Department. A fence constructed on a corner lot that extends past the rear of the house along the side yard or abuts an alley requires approval from the City Engineer (Section 5-5-5B of the Grand Junction Zoning and Development Code).

The owner/applicant must correctly identify all property lines, easements, and rights-of-way and ensure the fence is located within the property's boundaries. Covenants, conditions, restrictions, easements and/or rights-of-way may restrict or prohibit the placement of fence(s). The owner/applicant is responsible for compliance with covenants, conditions, and restrictions which may apply. Fences built in easements may be subject to removal at the property owner's sole and absolute expense. Any modification of design and/or material as approved in this fence permit must be approved, in writing, by the Community Development Department Director.

I hereby acknowledge that I have read this application and the information and plot plan are correct; I agree to comply with any and all codes, ordinances, laws, regulations, or restrictions which apply.

I understand that failure to comply shall result in legal action, which may include but not necessarily be limited to removal of the fence(s) at the owner's cost.

Applicant's Signature Adam Levinson

Community Development's Approval [Signature]

City Engineer's Approval (if required) _____

Date 9-11-98

Date 11-12-98

Date _____

VALID FOR SIX MONTHS FROM DATE OF ISSUANCE (Section 9-3-2D Grand Junction Zoning & Development Code)

(White: Community Development) (Yellow: Code Enforcement) (Pink: Customer)

xxxxxx cedar 6' Fence
Rock CLIFF WALL 8'

Adam, Tess LEVINSON
2372 RANA rd.
Ridges, Grand Junction,
colorado 81503

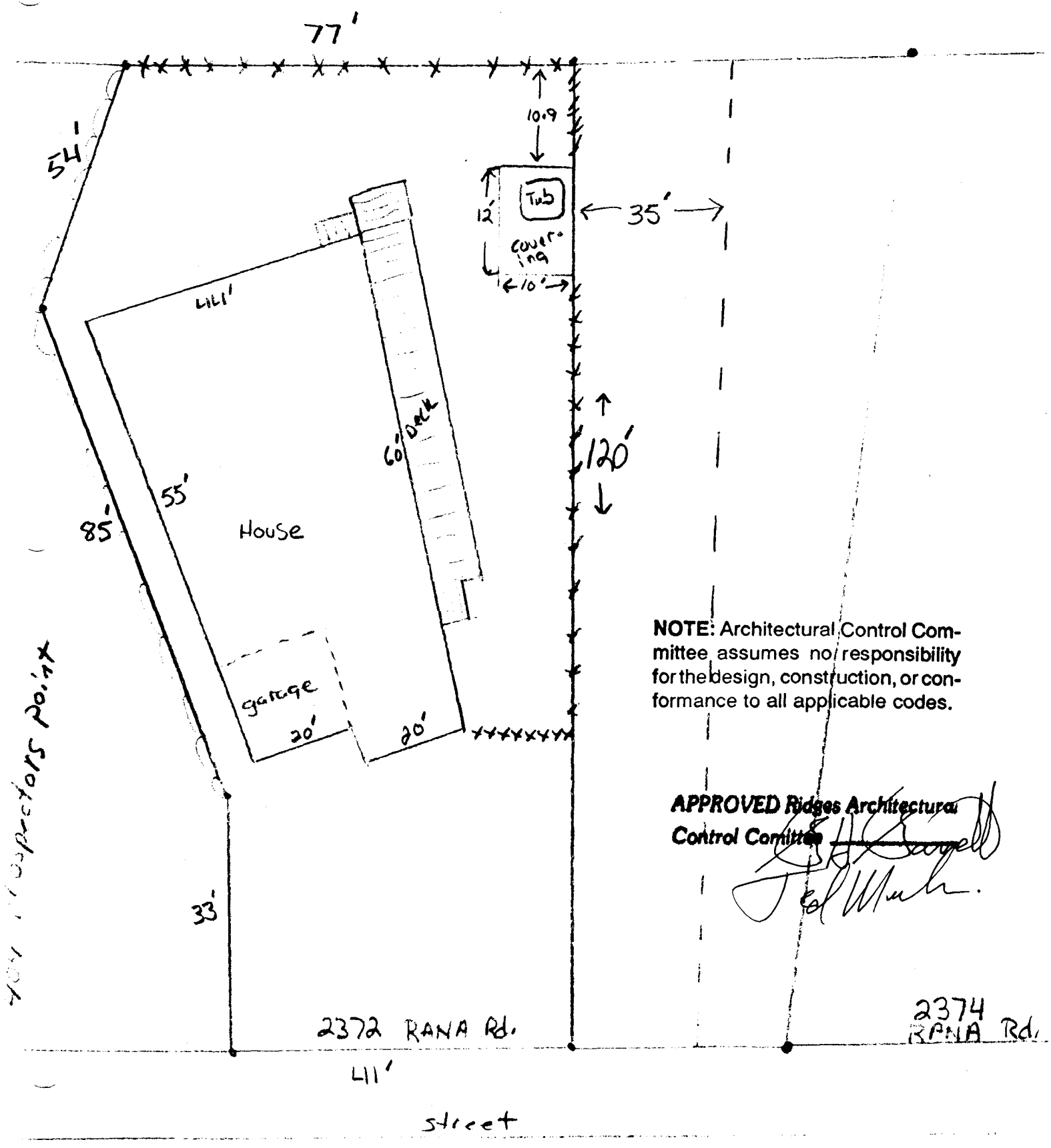

NOTE: Architectural Control Committee assumes no responsibility for the design, construction, or conformance to all applicable codes.

APPROVED Ridges Architectural
Control Committee
[Signature]
[Signature]

xxxxxx Inspectors Point

2372 RANA Rd.
411'

2374
RANA Rd.

Street