

FEE \$10.00

PERMIT # 10368

### FENCE PERMIT

#### GRAND JUNCTION COMMUNITY DEVELOPMENT DEPARTMENT

THIS SECTION TO BE COMPLETED BY APPLICANT

PLOT PLAN

PROPERTY ADDRESS 671 ~~ASHLEY~~ ATCHEE  
 TAX SCHEDULE NO 2945-032-36-001  
 PROPERTY OWNER DENNIS DERRIEUX  
 OWNER'S PHONE 257-7331  
 OWNER'S ADDRESS 671 ASHLEY  
 CONTRACTOR HENNI FENCING  
 CONTRACTOR'S PHONE 523-0955  
 FENCE MATERIAL CEDAR  
 FENCE HEIGHT 3' 4 1/2'

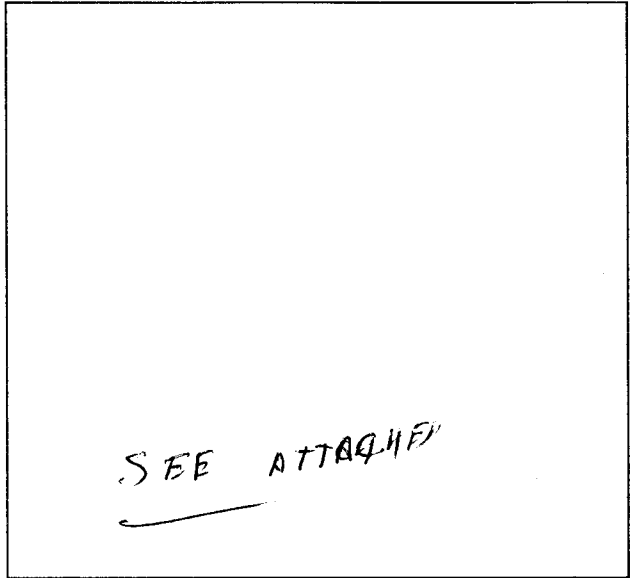

Plot plan must show property lines and property dimensions, all easements, all rights-of-way, all structures, all setbacks from property lines, & fence height(s).

THIS SECTION TO BE COMPLETED BY COMMUNITY DEVELOPMENT DEPARTMENT STAFF

ZONE PR 2.8  
 SPECIAL CONDITIONS not in  
40' sight D. -

SETBACKS: Front 20' from property line (PL) or  
45' from center of ROW, whichever is greater.  
 Side 0' from PL Rear 0' from PL

Fences exceeding six feet in height require a separate permit from the City/County Building Department. A fence constructed on a corner lot that extends past the rear of the house along the side yard or abuts an alley requires approval from the City Engineer (Section 5-5-5B of the Grand Junction Zoning and Development Code).

The owner/applicant must correctly identify all property lines, easements, and rights-of-way and ensure the fence is located within the property's boundaries. Covenants, conditions, restrictions, easements and/or rights-of-way may restrict or prohibit the placement of fence(s). The owner/applicant is responsible for compliance with covenants, conditions, and restrictions which may apply. Fences built in easements may be subject to removal at the property owner's sole and absolute expense. Any modification of design and/or material as approved in this fence permit must be approved, in writing, by the Community Development Department Director.

I hereby acknowledge that I have read this application and the information and plot plan are correct; I agree to comply with any and all codes, ordinances, laws, regulations, or restrictions which apply.

I understand that failure to comply shall result in legal action, which may include but not necessarily be limited to removal of the fence(s) at the owner's cost.

Applicant's Signature Jerry Henri

Date 5-28-98

Community Development's Approval Ronnie Edwards

Date 5-28-98

City Engineer's Approval (if required) NA

Date \_\_\_\_\_

VALID FOR SIX MONTHS FROM DATE OF ISSUANCE (Section 9-3-2D Grand Junction Zoning & Development Code)

(White: Community Development)

(Yellow: Code Enforcement)

(Pink: Customer)

NORTH  
↑

EXISTING FENCE

86' 3' solid (new)

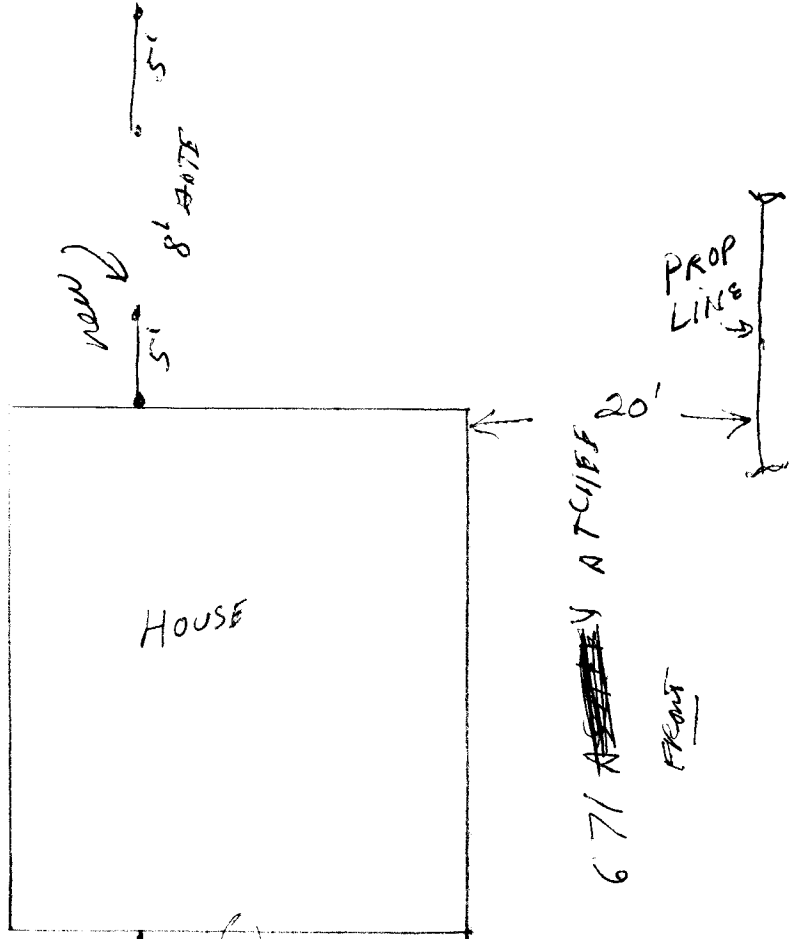

3' HIGH CEDAR

6' HIGH CEDAR

6' CEDAR FENCE

6' 7" ~~FRONT~~ ATCHIEF 20'

~~FRONT~~ ATCHIEF LANE

18"

SIDE WALK

WEST WOOD DRIVE

DEAD END