

FEE \$10.00

PERMIT # 10824



FENCE PERMIT
GRAND JUNCTIDN COMMUNITY DEVELOPMENT DEPARTMENT

②

THIS SECTION TO BE COMPLETED BY APPLICANT

PLOT PLAN

PROPERTY ADDRESS 1902 OURAy AVE

TAX SCHEDULE NO. 2945-131-19-029

PROPERTY OWNER CHRIS BETTRIDGE

OWNER'S PHONE 248-9017

DWNER'S ADDRESS 1902 OURAy AVE

CONTRACTOR Henni Fencing

CONTRACTOR'S PHONE 523-0955

CONTRACTOR'S ADDRESS 229 1/2 E / BERTHA LN

FENCE MATERIAL 6' CEDAR WOOD FENCE

FENCE HEIGHT 6'

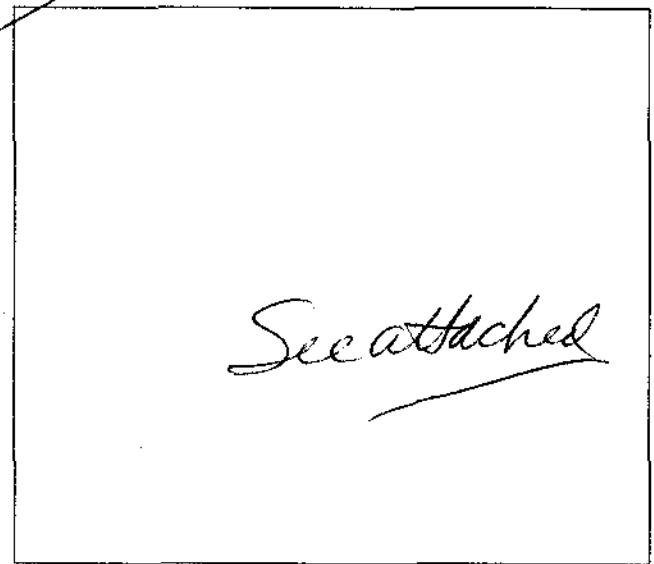

Plot plan must show property lines and property dimensions, all easements, all rights-of-way, all structures, all setbacks from property lines, & fence height(s).

THIS SECTION TO BE COMPLETED BY COMMUNITY DEVELOPMENT DEPARTMENT STAFF

ZONE RSF-8

SETBACKS: Front 20' from property line (PL) or
from center of ROW, whichever is greater.

SPECIAL CONDITIONS

Side 0' from PL Rear 0' from PL

Fences exceeding six feet in height require a separate permit from the City/County Building Department. A fence constructed on a corner lot that extends past the rear of the house along the side yard or abuts an alley requires approval from the City Engineer (Section 5-5-5B of the Grand Junction Zoning and Development Code).

The owner/applicant must correctly identify all property lines, easements, and rights-of-way and ensure the fence is located within the property's boundaries. Covenants, conditions, restrictions, easements and/or rights-of-way may restrict or prohibit the placement of fence(s). The owner/applicant is responsible for compliance with covenants, conditions, and restrictions which may apply. Fences built in easements may be subject to removal at the property owner's sole and absolute expense. Any modification of design and/or material as approved in this fence permit must be approved, in writing, by the Community Development Department Director.

I hereby acknowledge that I have read this application and the information and plot plan are correct; I agree to comply with any and all codes, ordinances, laws, regulations, or restrictions which apply.

I understand that failure to comply shall result in legal action, which may include but not necessarily be limited to removal of the fence(s) at the owner's cost.

Applicant's Signature Donna Henni

Date 6-21-99

Community Development's Approval Ronnie Edwards

Date 6-21-99

City Engineer's Approval (if required) N/A

Date

VALID FOR SIX MONTHS FROM DATE OF ISSUANCE (Section 9-3-2D Grand Junction Zoning & Development Code)
(White: Planning) (Yellow: Customer) (Pink: Code Enforcement)

ALLEY

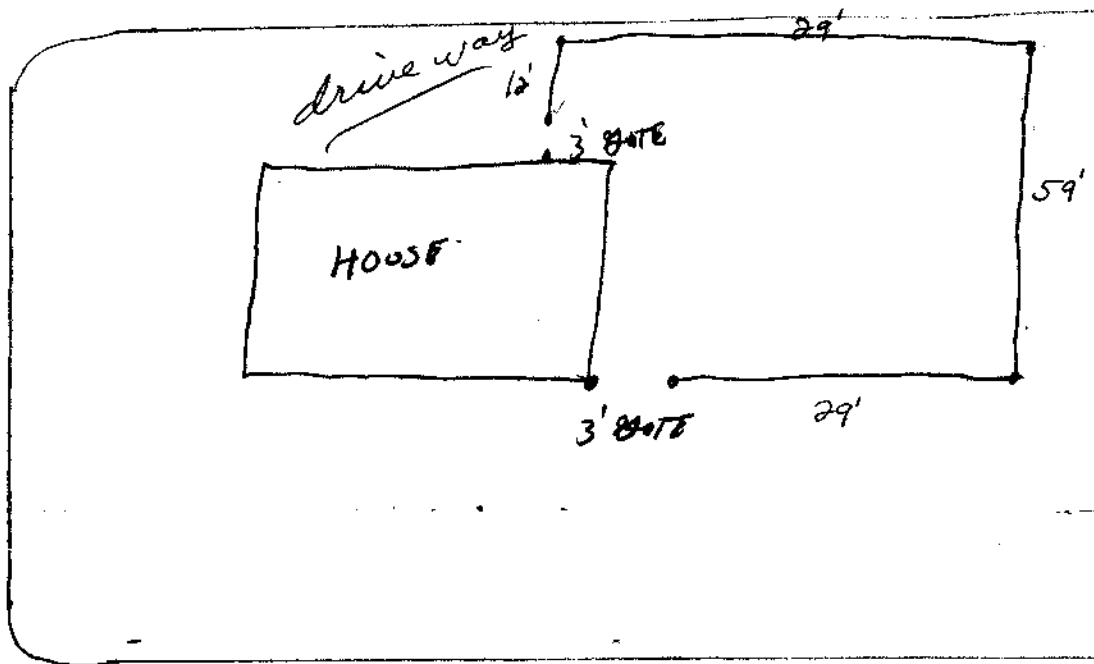

1974

OURAY

CHAS BETTRIDGE
1902 OURAY AVENUE
248-9017
6' CEDAR WOOD FENCE