

FEE \$10.00

PERMIT # 10924



FENCE PERMIT

GRAND JUNCTION COMMUNITY DEVELOPMENT DEPARTMENT

THIS SECTION TO BE COMPLETED BY APPLICANT

PROPERTY ADDRESS 2934 1/2 F Road
 TAX SCHEDULE NO. 2943-053-02-064
 PROPERTY OWNER Delbert Parmenter
 OWNER'S PHONE 434-7049
 OWNER'S ADDRESS 3210 E 1/2 Rd.
 CONTRACTOR Del Mar Const
 CONTRACTOR'S PHONE 434-7049
 CONTRACTOR'S ADDRESS 3210 E 1/2 Rd.
 FENCE MATERIAL Cedar
 FENCE HEIGHT 6'

PLOT PLAN

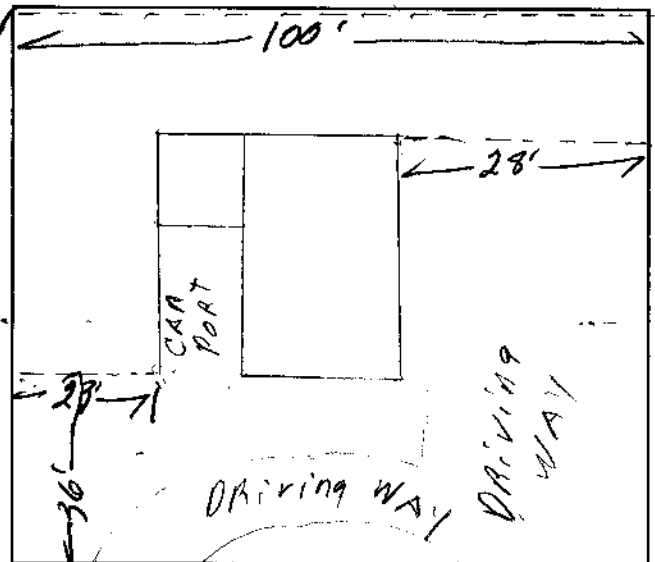

Plot plan must show property lines and property dimensions, all easements, all rights-of-way, all structures, all setbacks from property lines, & fence height(s).

THIS SECTION TO BE COMPLETED BY COMMUNITY DEVELOPMENT DEPARTMENT STAFF

ZONE PR 3.4
 SPECIAL CONDITIONS _____

SETBACKS: Front 20' from property line (PL) or
 _____ from center of ROW, whichever is greater.
 Side 0' from PL Rear 0' from PL

Fences exceeding six feet in height require a separate permit from the City/County Building Department. A fence constructed on a corner lot that extends past the rear of the house along the side yard or abuts an alley requires approval from the City Engineer (Section 5-5-5B of the Grand Junction Zoning and Development Code).

The owner/applicant must correctly identify all property lines, easements, and rights-of-way and ensure the fence is located within the property's boundaries. Covenants, conditions, restrictions, easements and/or rights-of-way may restrict or prohibit the placement of fence(s). The owner/applicant is responsible for compliance with covenants, conditions, and restrictions which may apply. Fences built in easements may be subject to removal at the property owner's sole and absolute expense. Any modification of design and/or material as approved in this fence permit must be approved, in writing, by the Community Development Department Director.

I hereby acknowledge that I have read this application and the information and plot plan are correct; I agree to comply with any and all codes, ordinances, laws, regulations, or restrictions which apply.

I understand that failure to comply shall result in legal action, which may include but not necessarily be limited to removal of the fence(s) at the owner's cost.

Applicant's Signature Delbert Parmenter
 Community Development's Approval Ronnie Edwards
 City Engineer's Approval (if required) _____

Date 10-21-99
 Date 10-21-99
 Date _____

VALID FOR SIX MONTHS FROM OATE OF ISSUANCE (Section 9-3-2D Grand Junction Zoning & Development Code)
 (White: Planning) (Yellow: Customer) (Pink: Code Enforcement)