

FEE \$10.00

PERMIT # 10901

AC



FENCE PERMIT
GRAND JUNCTION COMMUNITY DEVELOPMENT DEPARTMENT

THIS SECTION TO BE COMPLETED BY APPLICANT

PLOT PLAN

PROPERTY ADDRESS 111 Elm Ave
TAX SCHEDULE NO 2945-113-05-002
PROPERTY OWNER White
OWNER'S PHONE 242-3624
OWNER'S ADDRESS 111 Elm Ave
CONTRACTOR Taylor Fence
CONTRACTOR'S PHONE 241-1473
CONTRACTOR'S ADDRESS 832 2 1/2 Rd
FENCE MATERIAL PVC
FENCE HEIGHT 6' Tall

See the attached drawing

Plot plan must show property lines and property dimensions, all easements, all rights-of-way, all structures, all setbacks from property lines, & fence height(s).

THIS SECTION TO BE COMPLETED BY COMMUNITY DEVELOPMENT DEPARTMENT STAFF

ZONE RMF-5
SPECIAL CONDITIONS Fence is at least 20' back from front.

SETBACKS: Front 20' from property line (PL) or from center of ROW, whichever is greater.
Side 5' from PL Rear 25' from PL

Fences exceeding six feet in height require a separate permit from the City/County Building Department. A fence constructed on a corner lot that extends past the rear of the house along the side yard or abuts an alley requires approval from the City Engineer (Section 5-5-5B of the Grand Junction Zoning and Development Code).

The owner/applicant must correctly identify all property lines, easements, and rights-of-way and ensure the fence is located within the property's boundaries. Covenants, conditions, restrictions, easements and/or rights-of-way may restrict or prohibit the placement of fence(s). The owner/applicant is responsible for compliance with covenants, conditions, and restrictions which may apply. Fences built in easements may be subject to removal at the property owner's sole and absolute expense. Any modification of design and/or material as approved in this fence permit must be approved, in writing, by the Community Development Department Director.

I hereby acknowledge that I have read this application and the information and plot plan are correct; I agree to comply with any and all codes, ordinances, laws, regulations, or restrictions which apply.

I understand that failure to comply shall result in legal action, which may include but not necessarily be limited to removal of the fence(s) at the owner's cost.

Applicant's Signature Jerry Orman

Date 7-30-01

Community Development's Approval C. Fay Robinson

Date 7-30-01

City Engineer's Approval (if required)

Date

VALID FOR SIX MONTHS FROM DATE OF ISSUANCE (Section 9-3-2D Grand Junction Zoning & Development Code)
(White: Planning) (Yellow: Customer) (Pink: Code Enforcement)

WORK ORDER

TAYLOR FENCE COMPANY

TO Mr + Mrs White
11 Elm Ave
GJ Co 81501

DATE 7-16 20 01 **W 5374**
PHONE 242-3624
CUSTOMER'S ORDER NO.

TERMS SALESMAN Jerry O

| QUANTITY | DESCRIPTION | PRICE |
|----------|--------------------------------|-----------------|
| 104 | 6 white Basket weave pvc Fence | |
| 156 | 7/8 x 6" x 8' Rails | Set in Trussell |
| 13 | 7/8 x 3" x 6' mid Rails | |
| 26 | Plugs + screws | Locate 185587 |
| 11 | 5" x 5" x 9' Line post | |
| 2 | 5" x 5" x 9' End post | |
| 1 | 5" x 5" x 9' corner post | |
| 1 | 1 7/8 x 6' plate post | |
| 3 | 1 7/8 x 5" post Donuts | |
| 14 | 5" post caps | |

NOTES

HAUL Back ex Fence + Throw it in the Dumpster
Keep The Fence straight on Top

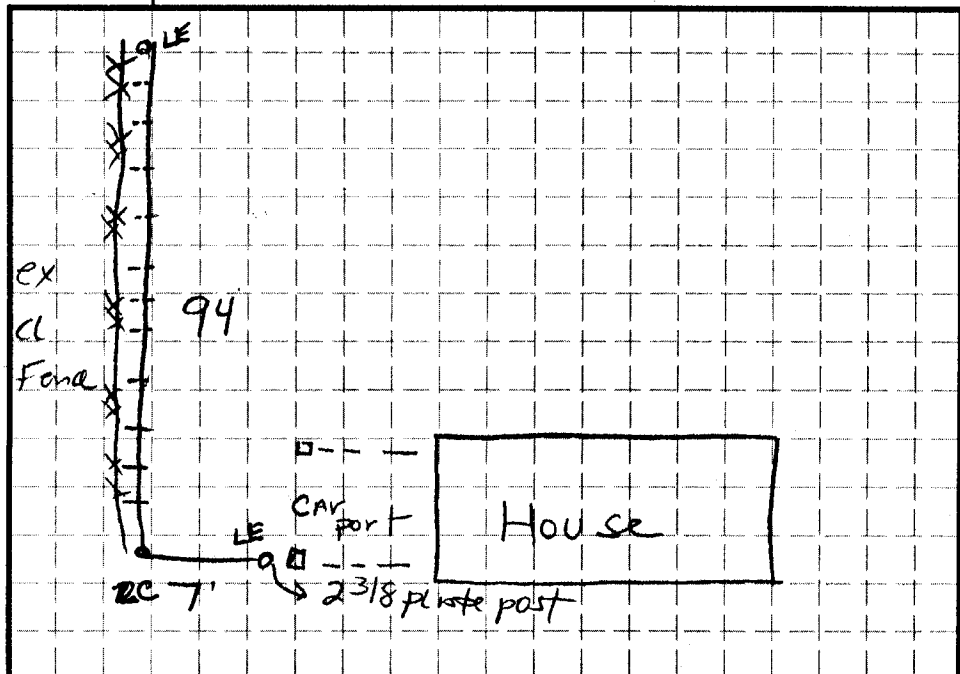

Elm Ave