

FEE \$10.00

PERMIT # 11654



FENCE PERMIT

GRAND JUNCTION COMMUNITY DEVELOPMENT DEPARTMENT

THIS SECTION TO BE COMPLETED BY APPLICANT *Renaissance*

PLOT PLAN

PROPERTY ADDRESS 2 446 Athens way
 TAX SCHEDULE NO. 2945-18308-009
 PROPERTY OWNER Cave, George
 OWNER'S PHONE 241-3079
 OWNER'S ADDRESS 446 Athens way
 CONTRACTOR Land Experts
 CONTRACTOR'S PHONE 464 0878
 CONTRACTOR'S ADDRESS 36786 4/022
 FENCE MATERIAL wood 1x6x6pa
 FENCE HEIGHT 6'

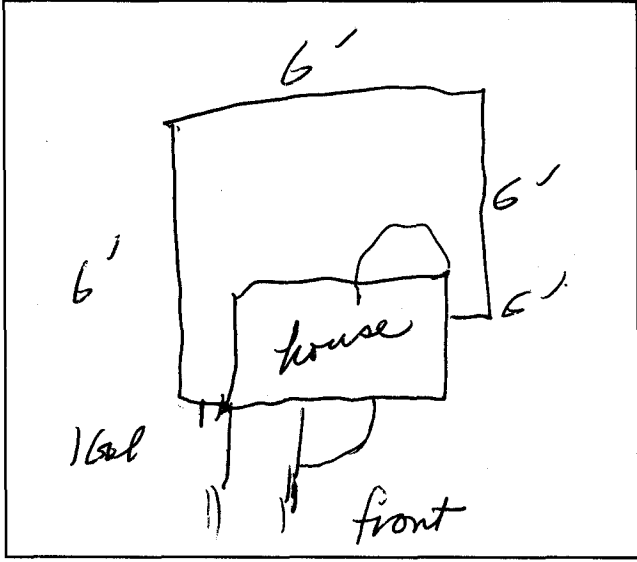

Plot plan must show property lines and property dimensions, all easements, all rights-of-way, all structures, all setbacks from property lines, & fence height(s).

THIS SECTION TO BE COMPLETED BY COMMUNITY DEVELOPMENT DEPARTMENT STAFF

ZONE RSF-4 SETBACKS: Front 20' from property line (PL) or
 SPECIAL CONDITIONS 5' drainage easements from center of ROW, whichever is greater.
on both sides of property - Side 0' from PL Rear 0' from PL

Fences exceeding six feet in height require a separate permit from the City/County Building Department. A fence constructed on a corner lot that extends past the rear of the house along the side yard or abuts an alley requires approval from the City Engineer (Section 5-5-5B of the Grand Junction Zoning and Development Code).

The owner/applicant must correctly identify all property lines, easements, and rights-of-way and ensure the fence is located within the property's boundaries. Covenants, conditions, restrictions, easements and/or rights-of-way may restrict or prohibit the placement of fence(s). The owner/applicant is responsible for compliance with covenants, conditions, and restrictions which may apply. Fences built in easements may be subject to removal at the property owner's sole and absolute expense. Any modification of design and/or material as approved in this fence permit must be approved, in writing, by the Community Development Department Director.

I hereby acknowledge that I have read this application and the information and plot plan are correct; I agree to comply with any and all codes, ordinances, laws, regulations, or restrictions which apply.

I understand that failure to comply shall result in legal action, which may include but not necessarily be limited to removal of the fence(s) at the owner's cost.

Applicant's Signature Chad H. Paul Date 4-30-01
 Community Development's Approval Ronnie Edwards Date 4-30-01
 City Engineer's Approval (if required) N/A Date _____

VALID FOR SIX MONTHS FROM DATE OF ISSUANCE (Section 9-3-2D Grand Junction Zoning & Development Code)
(White: Planning) (Yellow: Customer) (Pink: Code Enforcement)