

FEE \$10.00

PERMIT # 10885



FENCE PERMIT  
GRAND JUNCTION COMMUNITY DEVELOPMENT DEPARTMENT

THIS SECTION TO BE COMPLETED BY APPLICANT

PLOT PLAN

PROPERTY ADDRESS 634 Teller / 636 Teller Ave  
TAX SCHEDULE NO 2945-142-07-006  
PROPERTY OWNER Thad Harris  
OWNER'S PHONE 243-0303  
OWNER'S ADDRESS 2022 W Liberty Ct  
CONTRACTOR Taylor Fence of GJ  
CONTRACTOR'S PHONE 241-1473  
CONTRACTOR'S ADDRESS 832 2 1/2 Rd  
FENCE MATERIAL Chainlink  
FENCE HEIGHT 48"

See the Attached Drawing

Plot plan must show property lines and property dimensions, all easements, all rights-of-way, all structures, all setbacks from property lines, & fence height(s).

THIS SECTION TO BE COMPLETED BY COMMUNITY DEVELOPMENT DEPARTMENT STAFF

ZONE RMF-8 SETBACKS: Front 20' from property line (PL) or  
SPECIAL CONDITIONS \_\_\_\_\_ from center of ROW, whichever is greater.  
Side 0' from PL Rear 0' from PL

Fences exceeding six feet in height require a separate permit from the City/County Building Department. A fence constructed on a corner lot that extends past the rear of the house along the side yard or abuts an alley requires approval from the City Engineer (Section 5-5-5B of the Grand Junction Zoning and Development Code).

The owner/applicant must correctly identify all property lines, easements, and rights-of-way and ensure the fence is located within the property's boundaries. Covenants, conditions, restrictions, easements and/or rights-of-way may restrict or prohibit the placement of fence(s). The owner/applicant is responsible for compliance with covenants, conditions, and restrictions which may apply. Fences built in easements may be subject to removal at the property owner's sole and absolute expense. Any modification of design and/or material as approved in this fence permit must be approved, in writing, by the Community Development Department Director.

I hereby acknowledge that I have read this application and the information and plot plan are correct; I agree to comply with any and all codes, ordinances, laws, regulations, or restrictions which apply.

I understand that failure to comply shall result in legal action, which may include but not necessarily be limited to removal of the fence(s) at the owner's cost.

Applicant's Signature [Signature] Date 3-27-01  
Community Development's Approval [Signature] Date 3-28-01  
City Engineer's Approval (if required) N/A Date \_\_\_\_\_

VALID FOR SIX MONTHS FROM DATE OF ISSUANCE (Section 9-3-2D Grand Junction Zoning & Development Code)  
(White: Planning) (Yellow: Customer) (Pink: Code Enforcement)

WORK ORDER

# TAYLOR FENCE COMPANY

TO Thad Harris

DATE 3/26/42

**W 5384**

634 Teller + 636 Teller

PHONE 243-0303

Grand Junction

CUSTOMER'S ORDER NO.

TERMS

SALESMAN TS

QUANTITY	DESCRIPTION	PRICE
102'	48" X 11" gal. chain link complete	
4	2 3/4" X 6' latch post	
6	2 3/4" X 6' ENDS	
4	2 3/4" X 6' CORNERS	
3	4' X 48" walk gates	
1	3' X 48" walk gate	

DO ASAP

NOTE:  
11 sec me before - TS

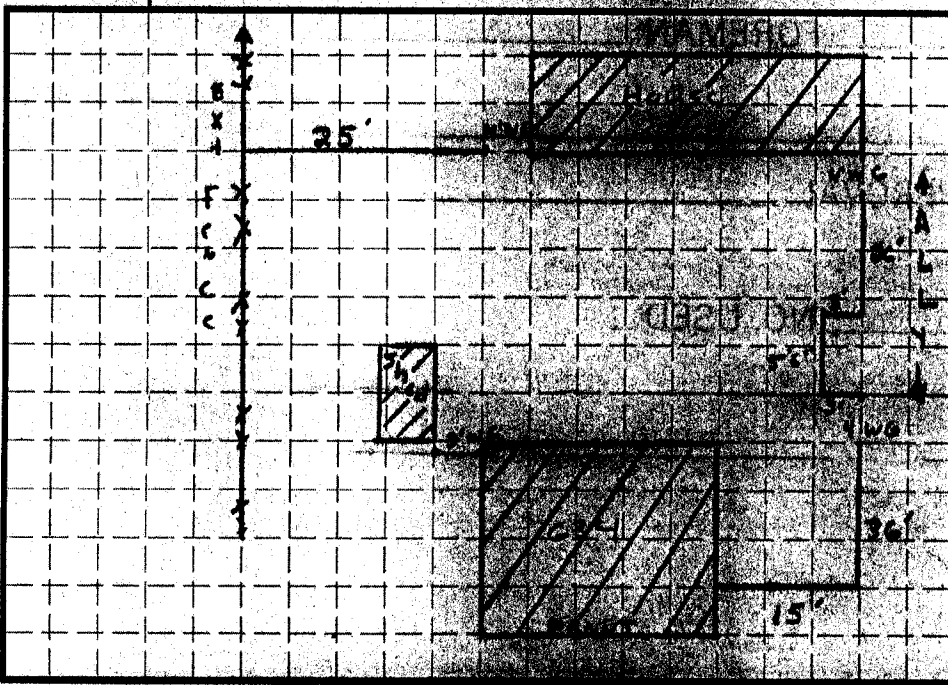

← Teller  
↓ Front