

FEE \$10.00

PERMIT # 11574

A



# FENCE PERMIT

## GRAND JUNCTION COMMUNITY DEVELOPMENT DEPARTMENT

THIS SECTION TO BE COMPLETED BY APPLICANT

PLOT PLAN

PROPERTY ADDRESS 838 White Avenue  
 TAX SCHEDULE NO. 2945-144-04-011  
 PROPERTY OWNER Vincent King / Sandra Alexander  
 OWNER'S PHONE (970) 241-9057  
 OWNER'S ADDRESS Same  
 CONTRACTOR N/A  
 CONTRACTOR'S PHONE N/A  
 CONTRACTOR'S ADDRESS N/A  
 FENCE MATERIAL Cedar  
 FENCE HEIGHT East-4 1/2', West-6'

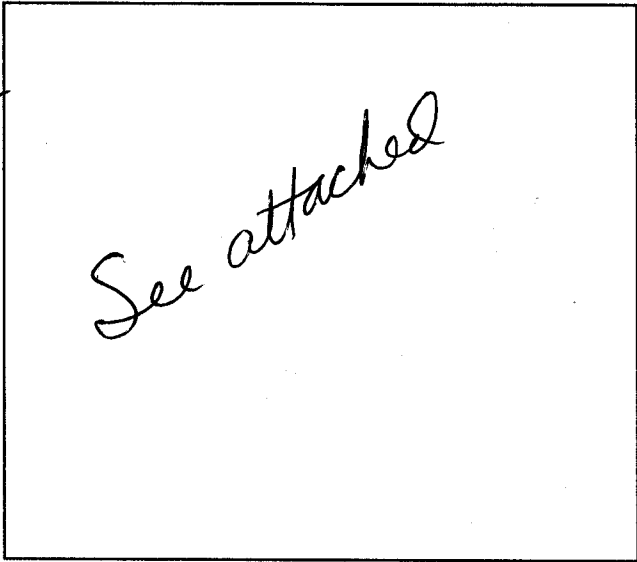

Plot plan must show property lines and property dimensions, all easements, all rights-of-way, all structures, all setbacks from property lines, & fence height(s).

THIS SECTION TO BE COMPLETED BY COMMUNITY DEVELOPMENT DEPARTMENT STAFF

ZONE R-0  
 SPECIAL CONDITIONS \_\_\_\_\_  
 \_\_\_\_\_

SETBACKS: Front 20' from property line (PL) or \_\_\_\_\_ from center of ROW, whichever is greater.  
 Side 0' from PL Rear 0' from PL

Fences exceeding six feet in height require a separate permit from the City/County Building Department. A fence constructed on a corner lot that extends past the rear of the house along the side yard or abuts an alley requires approval from the City Engineer (Section 5-5-5B of the Grand Junction Zoning and Development Code).

The owner/applicant must correctly identify all property lines, easements, and rights-of-way and ensure the fence is located within the property's boundaries. Covenants, conditions, restrictions, easements and/or rights-of-way may restrict or prohibit the placement of fence(s). The owner/applicant is responsible for compliance with covenants, conditions, and restrictions which may apply. Fences built in easements may be subject to removal at the property owner's sole and absolute expense. Any modification of design and/or material as approved in this fence permit must be approved, in writing, by the Community Development Department Director.

I hereby acknowledge that I have read this application and the information and plot plan are correct; I agree to comply with any and all codes, ordinances, laws, regulations, or restrictions which apply.

I understand that failure to comply shall result in legal action, which may include but not necessarily be limited to removal of the fence(s) at the owner's cost.

Applicant's Signature Sandra Alexander

Date 2/9/01

Community Development's Approval Ronnie Edwards

Date 2/9/01

City Engineer's Approval (if required) N/A

Date \_\_\_\_\_

VALID FOR SIX MONTHS FROM DATE OF ISSUANCE (Section 9-3-2D Grand Junction Zoning & Development Code)  
(White: Planning) (Yellow: Customer) (Pink: Code Enforcement)

# Proposal



P.O. Box 9220  
Grand Junction, CO 81501  
970-241-9303

Proposal Submitted To <b>Sandra <del>Alexandra</del> Alexander</b>	Type of Fencing 2x2 Deck Fence, 50'	Footage 1x6 Picture frame 80'
Street 838 White Av.	City, State, Zip Grand Jct, Co. 81501	
Phone 241-9057	Date of Bid 1/6/2001	4-Steel frame or Z frame walk gates.

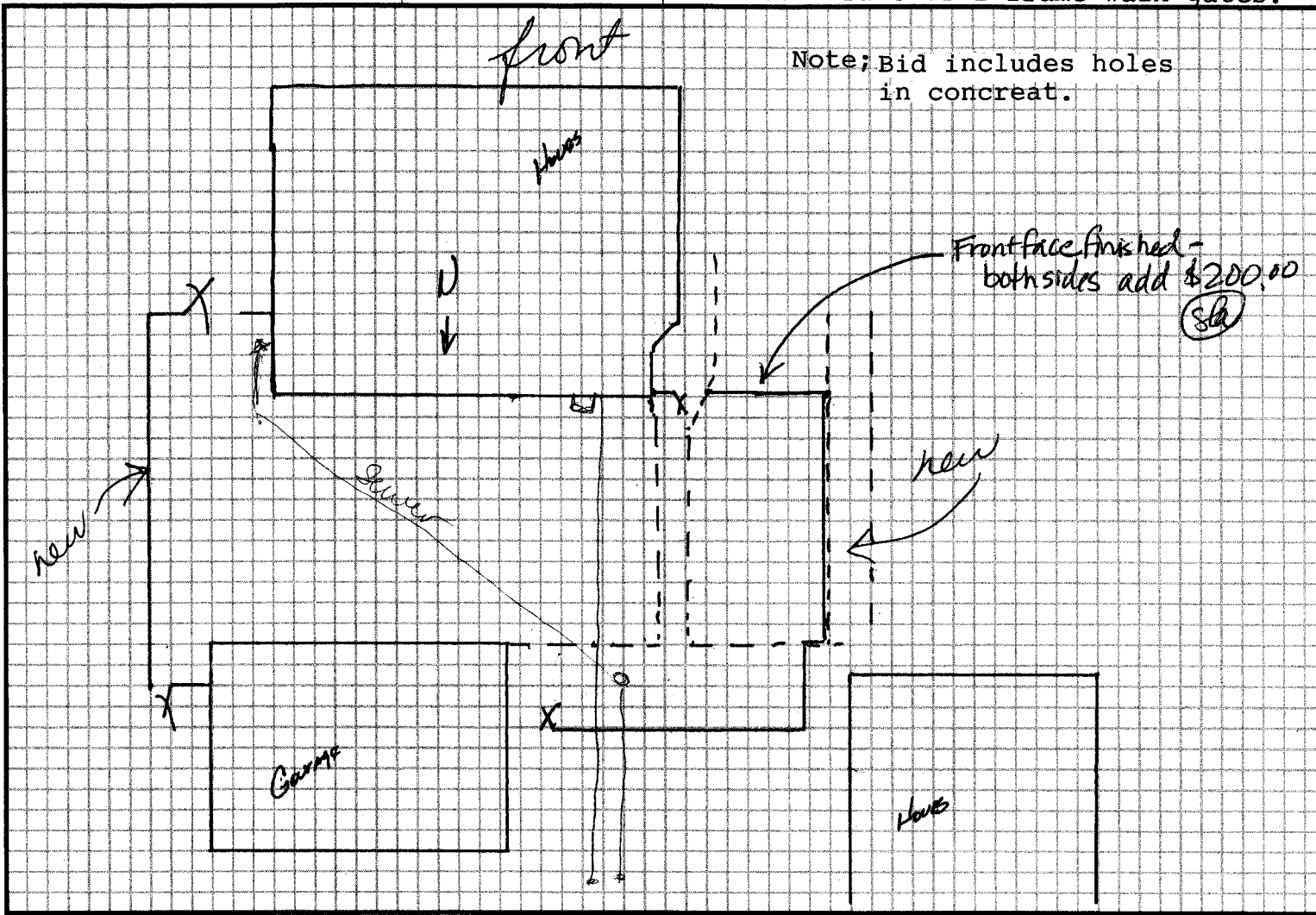

We Propose hereby to furnish material and labor – complete in accordance with above specifications, for the sum of:

75% is required up front, balance due on completion dated 6,000.00 dollars (\$ 5,800.00 )

Payment to be made as follows:

Billing, s over 30 days will be charge 1.5% intrest per month. Thank you.

All material is guaranteed to be as specified. All work to be completed in a workmanlike manner according to standard practices. Any alteration or deviation from above specifications involving extra costs will be executed only upon written orders, and will become an extra charge over and above the estimate. All agreements contingent upon strikes, accidents or delays beyond our control. Owner to carry fire, tornado and other necessary insurance. Our workers are fully covered by Workman's Compensation Insurance.

Authorized Signature [Signature]

Note: This proposal may be withdrawn by us if not accepted within 60 days.

**Acceptance of Proposal** – The above prices, specifications and conditions are satisfactory and are hereby accepted. You are authorized to do the work as specified. Payment will be made as outlined above.

Signature X [Signature]

Date of Acceptance: X 1/28/2001

Signature [Signature]

It is the PURCHASER'S responsibility to direct placement of the fence and Maranatha Fencing assumes no responsibility as to future property line disputes, or private underground utilities.