

FENCE PERMIT

GRAND JUNCTION COMMUNITY DEVELOPMENT DEPARTMENT



THIS SECTION TO BE COMPLETED BY APPLICANT

PLOT PLAN

PROPERTY ADDRESS 662 Cordial Ct.
TAX SCHEDULE NO 2945-021-18-010
PROPERTY OWNER Mr. + Mrs. Bynum
OWNER'S PHONE 970-255-1552
OWNER'S ADDRESS 662 Cordial Ct.
CONTRACTOR Taylor Fence Co.
CONTRACTOR'S PHONE 970-241-1473
CONTRACTOR'S ADDRESS 832 2 1/2 Road
FENCE MATERIAL Wood + Chainlink
FENCE HEIGHT 6' + 4'

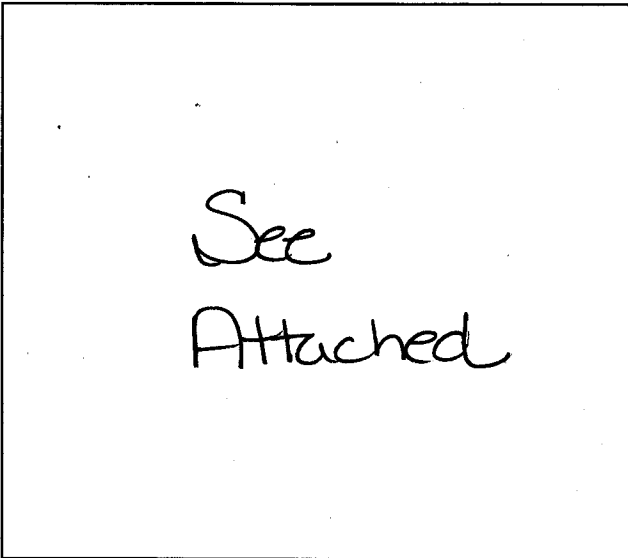

Plot plan must show property lines and property dimensions, all easements, all rights-of-way, all structures, all setbacks from property lines, & fence height(s). NOTE: PROPERTY LINE IS LIKELY ONE FOOT OR MORE BEHIND THE SIDEWALK.

THIS SECTION TO BE COMPLETED BY COMMUNITY DEVELOPMENT DEPARTMENT STAFF

ZONE RSF-4
SPECIAL CONDITIONS Churchill Sub
Fence along Dahlia has to be at least 5' behind sidewalk
SETBACKS: Front 20' from property line (PL) or from center of ROW, whichever is greater.
Side 0' from PL Rear 0' from PL

Fences exceeding six feet in height require a separate permit from the City/County Building Department. A fence constructed on a corner lot that extends past the rear of the house along the side yard or abuts an alley requires approval from the City Engineer (Section 4.1.J of the Grand Junction Zoning and Development Code).

The owner/applicant must correctly identify all property lines, easements, and rights-of-way and ensure the fence is located within the property's boundaries. Covenants, conditions, restrictions, easements and/or rights-of-way may restrict or prohibit the placement of fence(s). The owner/applicant is responsible for compliance with covenants, conditions, and restrictions which may apply. Fences built in easements may be subject to removal at the property owner's sole and absolute expense. Any modification of design and/or material as approved in this fence permit must be approved, in writing, by the Community Development Department Director.

I hereby acknowledge that I have read this application and the information and plot plan are correct; I agree to comply with any and all codes, ordinances, laws, regulations, or restrictions which apply. I understand that failure to comply shall result in legal action, which may include but not necessarily be limited to removal of the fence(s) at the owner's cost.

Applicant's Signature Donna Mathieu Date 10-24-02
Community Development's Approval C. Faye Johnson Date 10/29/02
City Engineer's Approval (if required) Date

VALID FOR SIX MONTHS FROM DATE OF ISSUANCE (Section 2.2.E.1.d Grand Junction Zoning & Development Code)
(White: Planning) (Yellow: Customer) (Pink: Code Enforcement)

Need Fence permit Locate whole yard

WORK ORDER

# TAYLOR FENCE COMPANY

TO Mr + Mrs Bynum  
 662 Cordial Court  
 GJ Co 81506

DATE 10-24-02 W  
 PHONE 255-1552  
 CUSTOMER'S  
 ORDER NO.

TERMS off Dahlia Ct + 26 1/2

SALESMAN Terry O

QUANTITY	DESCRIPTION	PRICE
201'	610 p/s 1x6x6 good neighbor style cedar fence	
27	4x4x8 cedar post	Set N NAIL
84	2x4x8 cedar nails	Set N strength
6	2x4x10' cedar rails	
1	4'x6' wood walk gate	Locate #
1	10'x6' wood double drive Ringshank galv nails	
125'	48" Black vinyl chainlink complete	
126	6 p/s 1 3/8 x 2 1/2" TOP RAIL Black	
12	1 7/8 x 5'6" Line post Black	
12	1 7/8 x 1 3/8 Eye Tops Black	
	Tension wire + Hog Rings TIES	
2	2 3/8 x 6' Black vinyl Capped Ends complete	

I will line you in on the job  
 Keep track of time

4' Black vinyl cl Fence 125' on the back fence line on each end in 10'

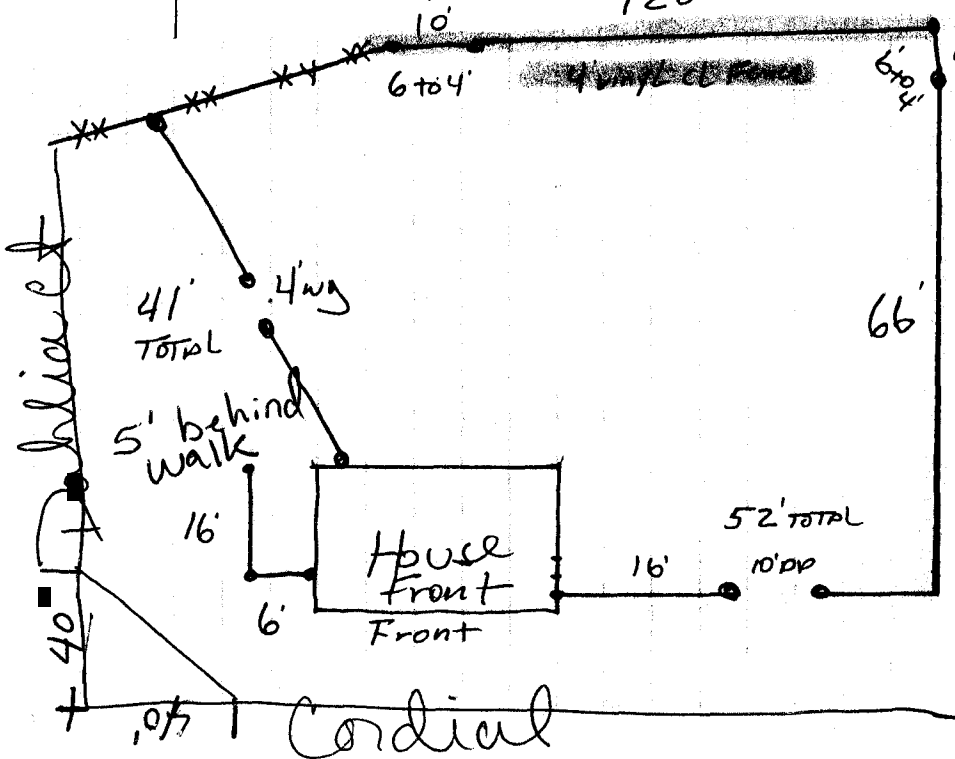

Drop from 6' down to 4' on the cedar

40' triangle measured from flow line of streets.