

FEL 0.00

City of GJ
250 N 5th St
GJ 81501
Comm Dev
PAH



FENCE PERMIT

GRAND JUNCTION COMMUNITY DEVELOPMENT DEPARTMENT

THIS SECTION TO BE COMPLETED BY APPLICANT

PLOT PLAN

PROPERTY ADDRESS 450 Ouray GJ 81501
 TAX SCHEDULE NO 2945-142-33-978
 PROPERTY OWNER Colorado West Mental Health
Cl to Joseph O'Connor
 OWNER'S PHONE 970 241 6023
 OWNER'S ADDRESS 740 Gunnison Ave GJ Co
81501
 CONTRACTOR na
 CONTRACTOR'S PHONE na
 CONTRACTOR'S ADDRESS na
 FENCE MATERIAL chain link
 FENCE HEIGHT 6' ~~height~~ 3 1/2' ~~height~~ 4' all around

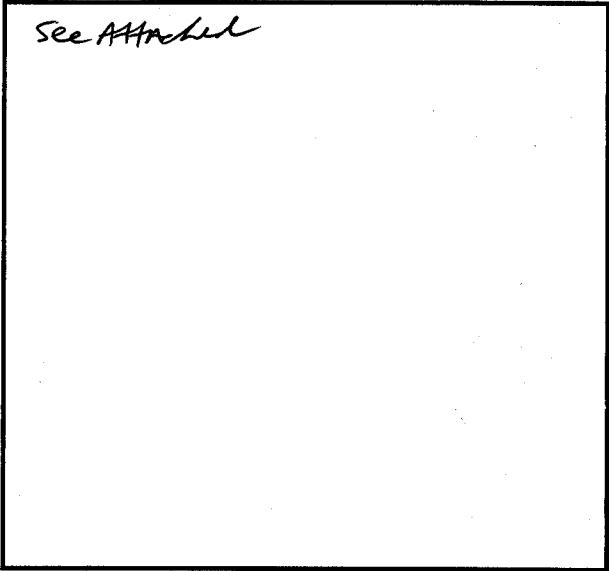

Plot plan must show property lines and property dimensions, all easements, all rights-of-way, all structures, all setbacks from property lines, & fence height(s). NOTE: PROPERTY LINE IS LIKELY ONE FOOT OR MORE BEHIND THE SIDEWALK.

THIS SECTION TO BE COMPLETED BY COMMUNITY DEVELOPMENT DEPARTMENT STAFF

ZONE BMF-24
 SPECIAL CONDITIONS _____

SETBACKS: Front 20' from property line (PL) or _____ from center of ROW, whichever is greater.
 Side 0' from PL Rear 0' from PL

Fences exceeding six feet in height require a separate permit from the City/County Building Department. A fence constructed on a corner lot that extends past the rear of the house along the side yard or abuts an alley requires approval from the City Engineer (Section 5-5-5B of the Grand Junction Zoning and Development Code).

The owner/applicant must correctly identify all property lines, easements, and rights-of-way and ensure the fence is located within the property's boundaries. Covenants, conditions, restrictions, easements and/or rights-of-way may restrict or prohibit the placement of fence(s). The owner/applicant is responsible for compliance with covenants, conditions, and restrictions which may apply. Fences built in easements may be subject to removal at the property owner's sole and absolute expense. Any modification of design and/or material as approved in this fence permit must be approved, in writing, by the Community Development Department Director.

I hereby acknowledge that I have read this application and the information and plot plan are correct; I agree to comply with any and all codes, ordinances, laws, regulations, or restrictions which apply. I understand that failure to comply shall result in legal action, which may include but not necessarily be limited to removal of the fence(s) at the owner's cost.

Applicant's Signature [Signature] Date 5.27.03
 Community Development's Approval [Signature] Date 5/27/03
 City Engineer's Approval (if required) _____ Date _____

VALID FOR SIX MONTHS FROM DATE OF ISSUANCE (Section 9-3-2D Grand Junction Zoning & Development Code)
(White: Planning) (Yellow: Customer) (Pink: Code Enforcement)

alley

Oasis Clubhouse
450 Ouray

Jana Hill
241-6099

Garage

Parking

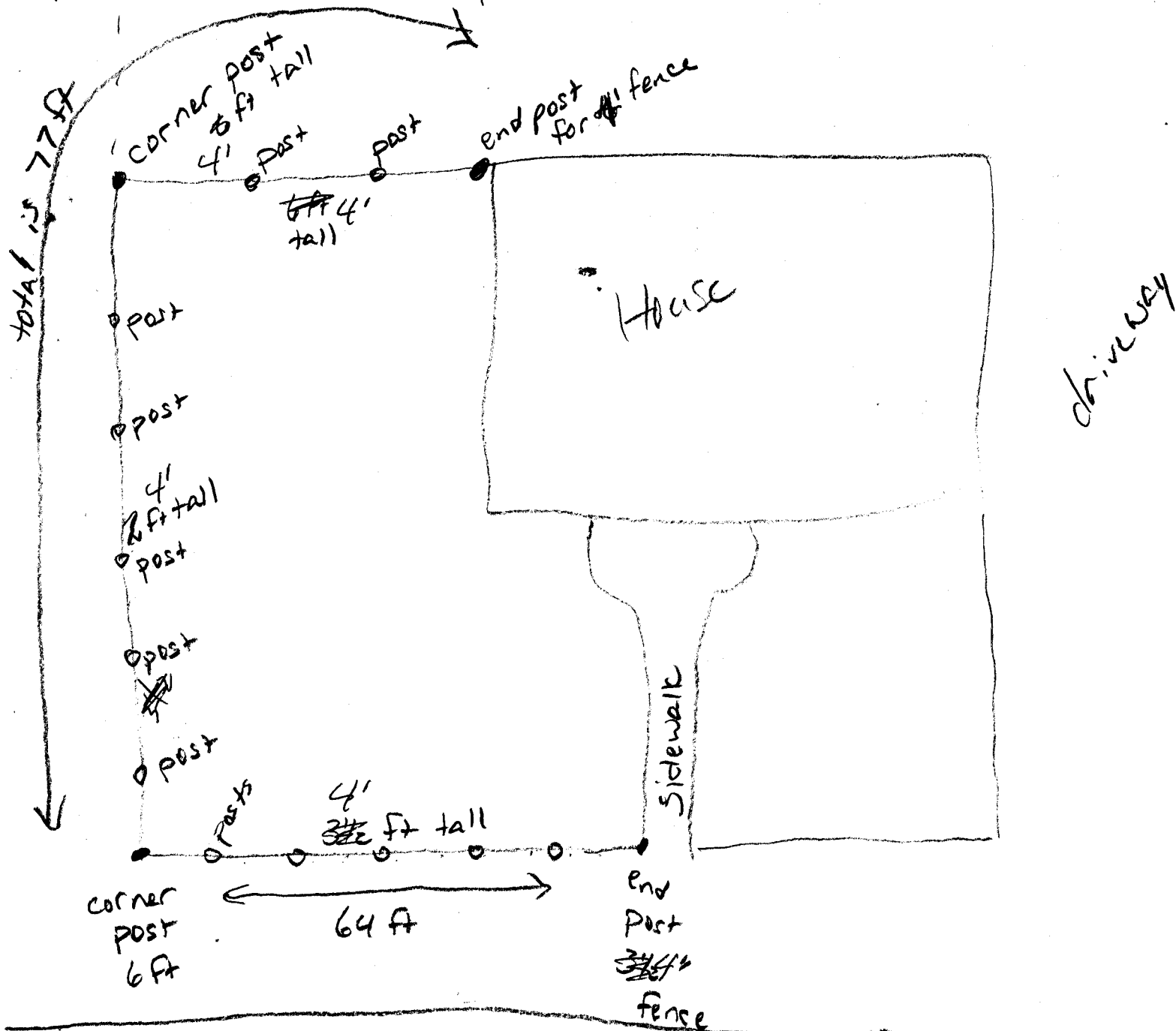

- 1 end for 6'
- 2 corners for 6'
- 1 end for 3 1/2'
- 7 posts for 6'
- 5 posts for 3 1/2'
- top pieces, post tops, clamps

We have chain link already
need everything else

N
W/E
S