

FENCE PERMIT

GRAND JUNCTION COMMUNITY DEVELOPMENT DEPARTMENT



THIS SECTION TO BE COMPLETED BY APPLICANT

PLOT PLAN

PROPERTY ADDRESS 588 N. Commercial Dr.
TAX SCHEDULE NO 2945-102-14-013 1-014
PROPERTY OWNER Elsteph Investment Co.
OWNER'S PHONE 245-9316
OWNER'S ADDRESS 2505 Foresight Circle #A
CONTRACTOR Maramtha Fencing
CONTRACTOR'S PHONE 241-9303
CONTRACTOR'S ADDRESS 2139 W. 12th St #10
FENCE MATERIAL chain link
FENCE HEIGHT 6'

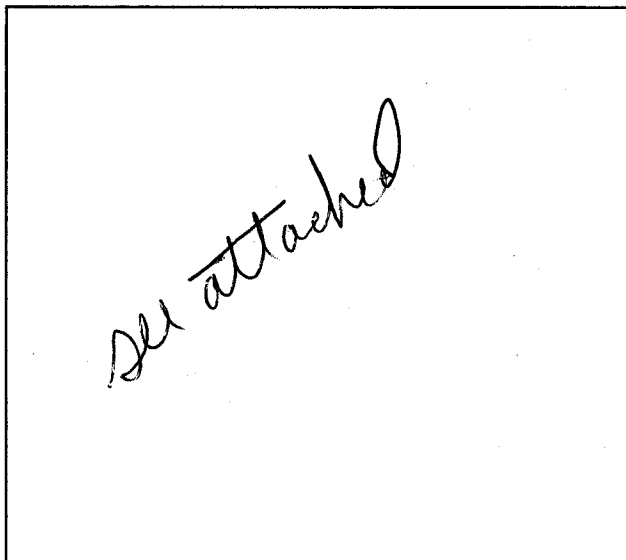

Plot plan must show property lines and property dimensions, all easements, all rights-of-way, all structures, all setbacks from property lines, & fence height(s). NOTE: PROPERTY LINE IS LIKELY ONE FOOT OR MORE BEHIND THE SIDEWALK.

THIS SECTION TO BE COMPLETED BY COMMUNITY DEVELOPMENT DEPARTMENT STAFF

ZONE C-1
SPECIAL CONDITIONS
SETBACKS: Front 0' from property line (PL) or from center of ROW, whichever is greater.
Side 0' from PL Rear 0' from PL

Fences exceeding six feet in height require a separate permit from the City/County Building Department. A fence constructed on a corner lot that extends past the rear of the house along the side yard or abuts an alley requires approval from the City Engineer (Section 4.1.J of the Grand Junction Zoning and Development Code).

The owner/applicant must correctly identify all property lines, easements, and rights-of-way and ensure the fence is located within the property's boundaries. Covenants, conditions, restrictions, easements and/or rights-of-way may restrict or prohibit the placement of fence(s). The owner/applicant is responsible for compliance with covenants, conditions, and restrictions which may apply. Fences built in easements may be subject to removal at the property owner's sole and absolute expense. Any modification of design and/or material as approved in this fence permit must be approved, in writing, by the Community Development Department Director.

I hereby acknowledge that I have read this application and the information and plot plan are correct; I agree to comply with any and all codes, ordinances, laws, regulations, or restrictions which apply. I understand that failure to comply shall result in legal action, which may include but not necessarily be limited to removal of the fence(s) at the owner's cost.

Applicant's Signature [Signature] Date 3/24/03
Community Development's Approval [Signature] Date 3/24/03
City Engineer's Approval (if required) Date

VALID FOR SIX MONTHS FROM DATE OF ISSUANCE (Section 2.2.E.1.d Grand Junction Zoning & Development Code)
(White: Planning) (Yellow: Customer) (Pink: Code Enforcement)

Proposal



PMB 9220
2139 N. 12th St., Unit 10
Grand Junction, CO 81501-7600
970-241-9303

Attn: Jan

Proposal Submitted To Just Co.	Type of Fencing 6' Cl 11ga.	Footage 171'
Street 588 N comercial Dr	1- 14' D.D gate.	
City, State, Zip Grand Jct, Co. 81505		
Phone 245-9316	Date of Bid 3/14/03	

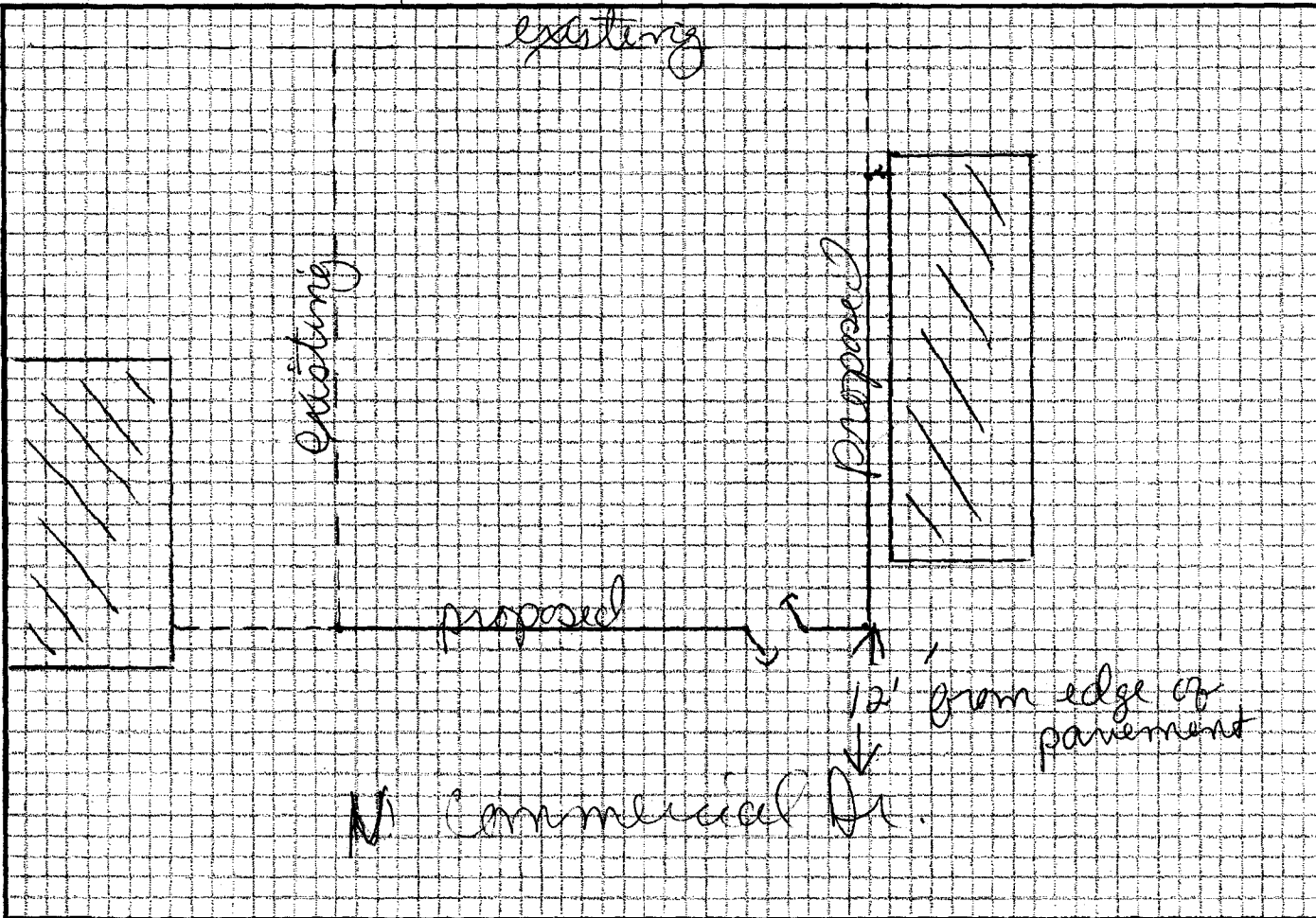

We Propose hereby to furnish material and labor - complete in accordance with above specifications, for the sum of:

50% is required up front for material & handling, _____ dollars (\$ **1,445.00**)

Payment to be made as follows:

balance is due on completion date. Thank you.

All material is guaranteed to be as specified. All work to be completed in a workmanlike manner according to standard practices. Any alteration or deviation from above specifications involving extra costs will be executed only upon written orders, and will become an extra charge over and above the estimate. All agreements contingent upon strikes, accidents or delays beyond our control. Owner to carry fire, tornado and other necessary insurance. Our workers are fully covered by Workman's Compensation Insurance.

Authorized Signature

Note: This proposal may be withdrawn by us if not accepted within 90 days.
Terms and Conditions: The net balance is due and payable upon job completion.
A finance charge of 1.5% per month will be added after 30 days.

Acceptance of Proposal - The above prices, specifications and conditions are satisfactory and are hereby accepted. You are authorized to do the work as specified. Payment will be made as outlined above.

Signature _____

Date of Acceptance: _____

Signature _____

It is the PURCHASER'S responsibility to direct placement of the fence and Maranatha Fencing assumes no responsibility as to future property line disputes, or private underground utilities.